

PEUGEOT
MOTORCYCLES



PEUGEOT
MOTORCYCLES

PEUGEOT TWEET

Notice d'utilisation

User's manual



Notice d'utilisation

FR

Owner's manual

GB

Bedienungsanleitung

DE

Libretto d'istruzioni

IT

Manual de utilización

ES

Gebruikershandleiding

NL

ΕΓΧΕΙΡΙΔΙΟ ΧΡΗΣΗΣ

GR

Instruktionsbok

SE

Manual de proprietário

PT

Käyttöohjekirja

FI

Instruktionsbog

DK

CONTENTS

Information	2	Replacing the air filter.....	19
Safety advice.....	2	Throttle cable play	19
Characteristics.....	3	Tyres	20
Vehicle identification	7	Brake inspection	20
Products to use	7	Brake fluid.....	21
Information about the instructions	8	Battery	22
Description of the vehicle	9	Extended periods of immobilisation and storage.....	22
Instruments	10	Fuses.....	23
Multi-function display	11	Fuse allocation	23
Controls	11	Bulb replacement.....	24
Key-operated ignition switch functions.....	12	Headlight bulb.....	24
Equipments	12	Indicator bulbs	24
Utility hanger	12	Rear light and indicator bulbs	24
Lateral stand.....	12	Number plate light bulb.....	24
Checks to perform before use	13	Headlight height adjustment.....	24
Advice for starting up and driving	13		
Warning	13		
Eco mode	13		
Driving on flooded roads	13		
Inspection before setting off	14		
Starting the engine	14		
Driving	14		
Braking	15		
Fuel-Fuel saving.....	15		
Running in the engine	16		
Switching off the engine and parking	16		
Service operations.....	17		
Maintenance advice	17		
Environment / Recyclable.....	17		
Cleaning the vehicle	17		
Spark plug inspection or replacement.....	17		
Checking the engine oil level.....	18		
Changing the engine oil.....	18		
Draining the relay box.....	19		

GB

INFORMATION

You have just bought a Peugeot vehicle.

We would like to thank you for purchasing one of our products.

Please take some time to read this manual carefully before using the vehicle.

This user manual should always be kept in the boot of the vehicle. It contains instructions for use, checks and maintenance of the vehicle, and important safety instructions intended to protect the user and third parties against accidents.

It will give you plenty of advice on how to keep your vehicle in full working order.

Your authorised dealer is familiar with all the vehicle's characteristics and has genuine spare parts and specific tools. He can advise you and service your vehicle in the best conditions according to the established service schedule to ensure that you can enjoy driving it in complete safety.

This manual must be considered as an integral part of the vehicle and must remain with it even if the vehicle is sold on.

In our permanent concern to make improvements PEUGEOT MOTOCYCLES reserves the right to suppress, modify, or add any reference mentioned.

SAFETY ADVICE

A inexperienced motorcyclist should make himself completely familiar with his vehicle before going out in traffic. You are strongly advised not to lend your vehicle to an inexperienced rider.

To ride a motorbike, you are required by law to hold a licence or to have completed specific training with a professional, depending on the applicable legislation and based on engine capacity.

Wearing an approved helmet and gloves is obligatory for the user and passenger. You are also advised to wear goggles and light-coloured or reflective clothing adapted to motorcycling.

In some countries, the applicable legislation may not authorise transportation of a passenger, and elsewhere it may oblige motorcycle users to contract a civil liability insurance policy to protect third parties and the passenger against potential damage resulting from an accident.

Driving whilst under the influence of alcohol, drugs or certain medicines is inexcusable and dangerous for yourself and others.

Excessive speed is an important factor in many accidents. You must observe the road signs and signals and adapt your speed to the weather conditions.

The engine and the exhaust system components can reach very high temperatures. When parking your vehicle, be careful to avoid contact with inflammable materials which could cause a fire or with parts of the body which could result in serious burns.

Luggage carriers and paniers approved by PEUGEOT MOTOCYCLES are available as options (depending on the model). Assembly instructions should be followed and the maximum permissible load which is between 3 and 5 kg depending on the equipment should not be exceeded.

Fitting accessories such as the driver's apron, top-case, etc. may affect the vehicle's stability (wind factor, load, etc.).

When riding the vehicle fitted with accessories, the driver should reduce speed.

Mounting adaptable parts that have not been approved by PEUGEOT MOTOCYCLES, which alter the technical characteristics or performances of the vehicle is forbidden. Any modification will invalidate the warranty and the vehicle will no longer be in compliance with the version approved by the appropriate services.

CHARACTERISTICS

	TWEET 50	TWEET 50 PRO	TWEET 125 CBS	TWEET 125 CBS PRO	TWEET 200 ABS
Official type-approval code	LW1AKA	LW1CKP LW1CKL	LW4CKA	LW4CKP LW4CKL	LW6EKB

GB

Dimensions in mm

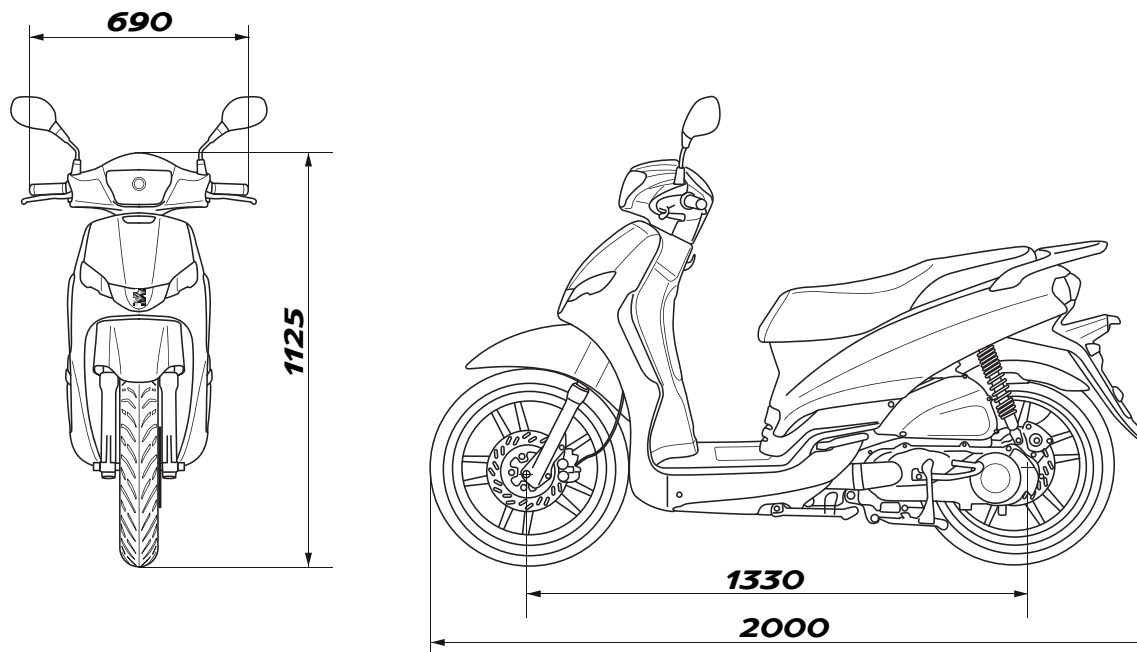

Weight in kg

Unladen weight.	97	114 (P) 118 (L)	114	119 (P) 120 (L)	114
In working order.	100	117 (P) 121 (L)	120	126 (P) 130 (L)	120
Authorised maximum. Total weight of the vehicle, the user, the passenger, the accessories and luggage.	250	227 (P) 266 (L)	270	236 (P) 256 (L)	270

CHARACTERISTICS

	TWEET 50	TWEET 50 PRO	TWEET 125 CBS	TWEET 125 CBS PRO	TWEET 200 ABS
Official type-approval code	LW1AKA	LW1CKP LW1CKL	LW4CKA	LW4CKP LW4CKL	LW6EKB
Engine					
Identification.	XS1P37QMA-3		XS1P52QMI-4A		XS1P61QMK-A
Engine type.	4-stroke single-cylinder. 2 valves.				
Cubic capacity.	50 cc		125 cc		170 cc
Bore x stroke in mm.	37 x 46 mm		52.4 x 57.8 mm		61 x 58.2 mm
Maximum power.	2.2 kW at 8000 rpm		7.5 kW at 8500 rpm		8.5 kW at 8000 rpm
Maximum torque.	3.0 Nm at 6000 rpm		9.2 Nm at 7000 rpm		11.2 Nm at 6000 rpm
Cooling.	Air cooling				
Fuel supply.	Indirect electronic injection (EFI)				
Spark plug.	NGK CR6HSA		NGK CR7HSA		
Lubrication.	Pressurised wet sump lubrication				
Exhaust.	Catalysed and lambda sensor				
Anti-pollution standard.	Euro 5		Euro 5		
Consumption ^a .	2.35 l/100		2.4 l/100		2.7 l/100
CO ² emission (On cycle).	53 g/km		53 g/km		58 g/km
Capacities in litres					
Engine oil. - Changing the engine oil	0.8 0.65 l at oil change		0.95 0.7 l at oil change		
Relay box oil.	0.18 0.17 l at oil change		0.18 0.17 l at oil change		
Fuel tank.	5.5	9	5.5	9	5.5
Fork oil.	0.1 l per tube. SAE10W		0.1 l per tube. SAE10W		

a. These consumption values are established according to the regulation 134/2014 Annex VII. They may vary according to driving behaviour, traffic conditions, weather conditions, the load in the vehicle, vehicle maintenance and use of the accessories...

CHARACTERISTICS

		TWEET 50	TWEET 50 PRO	TWEET 125 CBS	TWEET 125 CBS PRO	TWEET 200 ABS
Official type-approval code		LW1AKA	LW1CKP LW1CKL	LW4CKA	LW4CKP LW4CKL	LW6EKB
Tyre dimensions / Standard load index and speed rating						
Front.		90/80 - 16 52P or 110/70 - 16 51N		90/80 - 16 52P or 110/70 - 16 51N		
Minimum load index and speed rating.		29B		39J		
Rear.		90/80 - 16 52P or 110/70 - 16 51N		90/80 - 16 52P or 110/70 - 16 51N		
Minimum load index and speed rating.		45B		49J		
Pressure in bars						
Front.	Solo.	1.75		1.75		
	Pillion.	2.0		2.0		
Rear.	Solo.	2.0		2.0		
	Pillion.	2.25		2.25		
Suspension						
Front.		30 mm Ø telescopic front fork Travel: 100 mm		30 mm Ø telescopic front fork Travel: 100 mm		
Rear.		Adjustable shock absorber. Travel: 80 mm		2 adjustable shock absorbers. Travel: 75 mm		
Brakes						
Front.		1 disc Ø226 mm		1 disc Ø226 mm		1 disc Ø260 mm
Rear.		1 disc Ø226 mm or 1 drum Ø130 mm		1 disc Ø226 mm		1 disc Ø240 mm

GB

CHARACTERISTICS

	TWEET 50	TWEET 50 PRO	TWEET 125 CBS	TWEET 125 CBS PRO	TWEET 200 ABS
Official type-approval code	LW1AKA	LW1CKP LW1CKL	LW4CKA	LW4CKP LW4CKL	LW6EKB
Electrical equipment					
Headlights.	12V - 35/35W (HS1)		12V - 35/35W (HS1)		
"Side light" bulbs.	LED		LED		
Indicator bulbs.	12V - 10W		12V - 10W		
Rear light.	12V - 21/5W		12V - 21/5W		
Number plate light.	12V - 5W		12V - 5W		
Battery.	12V - 6Ah Maintenance-free batteries YUASA YTX7A-BS		12V - 6Ah Maintenance-free batteries YUASA YTX7A-BS		

VEHICLE IDENTIFICATION

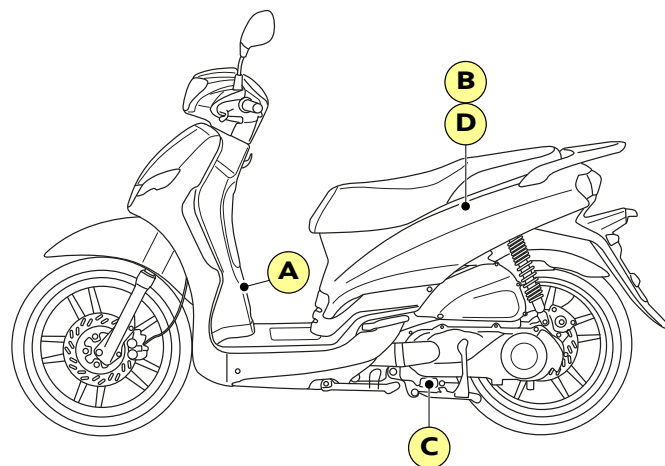

A. Vehicle identification number (V.I.N).

B. Manufacturer's plate.

C. Engine number.

D. Tyre pressure label.



Temperature variations modify tyre pressure.

The tyre pressure must be checked once a month when cold.

PRODUCTS TO USE

Lead-free petrol

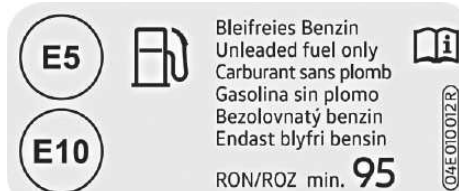

Engine oil

50 cc	SAE 5W40 Synthetic API SL/SJ
125/ 200 cc	SAE 10W30 Synthetic API SL/SJ SAE 5W40 Synthetic API SL/SJ SAE 15W50 Synthetic API SL/SJ

Relay box oil

SAE 80W90 API GL5

Fork oil

Hydraulic oil. SAE10W

Grease

High-temperature grease
Multi-use grease

Brake fluid

Brake fluid DOT 4

GB

INFORMATION ABOUT THE INSTRUCTIONS

Specific information is indicated by the following symbols:

GB



Möbius band

Recyclable.

Means that the product or the package can be recycled.



Explosive

The product may explode upon contact with a naked flame, spark or static electricity, or due to the effect of heat, an impact or friction.

Handle and keep away from heat sources and other causes of sparks.



Flammable

The product may ignite in contact with a naked flame, a spark or static electricity, or due to the effect of heat, friction, in contact with the air or in contact with water, releasing inflammable gases.

Handle and keep away from heat sources and other causes of sparks.



Corrosive

The product is corrosive.

It can attack (corrode) or destroy metals.

Contact with the product or splashes of the product may burn the skin and cause lesions to the eyes. Avoid any contact with the eyes and skin. Do not inhale.



Harmful to health

The product can be poisonous in high doses.

It may irritate the skin, eyes and airways.

It may cause skin allergies.

It may cause drowsiness or dizziness. Avoid all contact with the product.



Toxic or fatal

The product can rapidly be fatal.

It poisons rapidly, even at low doses. Wear protective equipment.

Avoid any contact (oral, skin, inhalation) with the product and wash all exposed areas carefully after use.



Harmful for the environment

The product pollutes.

It has a harmful effect (in the short and/or long term) on organisms in aquatic environments.

Do not dispose of it in the environment.



Do not throw away into a garbage can

One of the product's component is toxic and can be hazardous to environment. Do not throw the used product in the dustbin. Take it back to the trader or to a specific waste disposal site.



People's safety

Operation that can be dangerous for people.

People's safety can be seriously affected if the recommendations are not fully respected.



Important

Operation that can be hazardous to the vehicle.

Indicate the specific procedures that shall be followed in order not to damage the vehicle.



Note

Gives key information concerning operation of the vehicle.

DESCRIPTION OF THE VEHICLE

1. Instrument panel
2. Utility hanger
3. Glove box
4. Fuel tank
5. Grab handle
6. Kick starter¹
7. Central stand
8. Passenger footrests
9. Lateral stand
10. Left brake lever
11. Brake fluid level
12. Circuit breaker¹
13. Helmet compartment
14. Ignition switch
15. Throttle
16. Right brake lever
17. Battery / Fuses
18. Oil level gauge

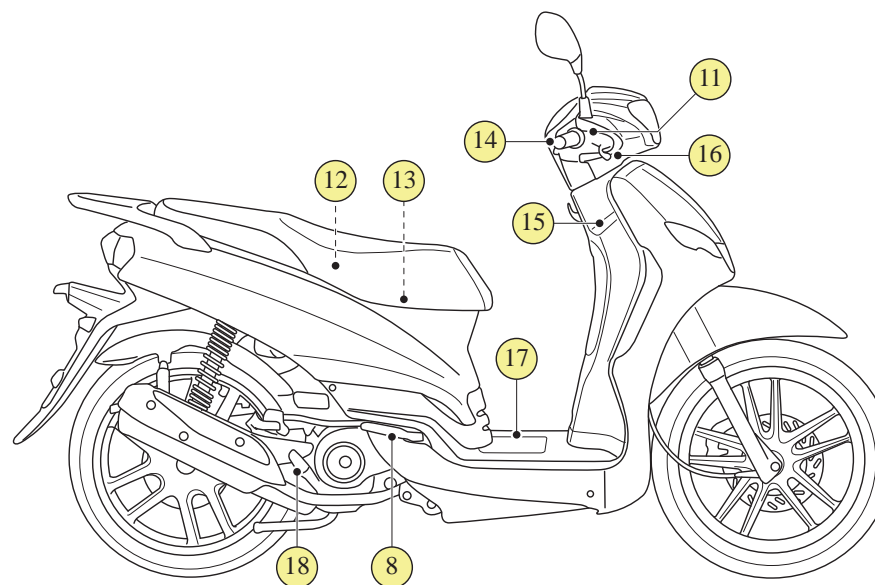
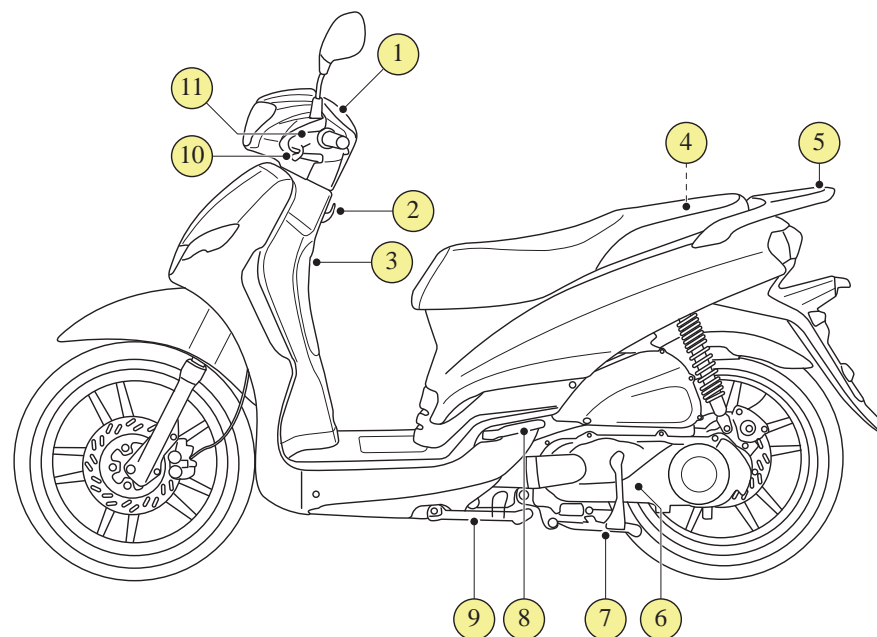

1. Depending on model

INSTRUMENTS

TWEET 50 cc

1. Speedometer

Double-scale speedometer showing kilometers and miles.

2. Main beam control

3. Direction indicator warning light

4. Odometer

5. Fuel gauge

6. Emissions control system failure warning light (MIL. Malfunction Indicator Lamp)

If the indicator light turns on when riding, you are advised to have the vehicle checked by an authorised dealer.

TWEET 125/200 cc

The instrument panel initializes itself every time the ignition is switched on.

1. Speedometer

Double-scale speedometer showing kilometers and miles.

2. Main beam control

3. Direction indicator warning light

When a flasher bulb has failed the repeater light and the other flasher light flash more quickly to alert the rider of a failure.

4. Emissions control system failure warning light (MIL. Malfunction Indicator Lamp)

If the indicator light turns on when riding, you are advised to have the vehicle checked by an authorised dealer.

5. Multi-function display

(see relevant chapter)

6. Brake system management indicator light ABS¹

If the indicator light turns on intermittently or remains on, you are advised to stop the vehicle and have it checked by an authorised dealer.

7. Display control knob

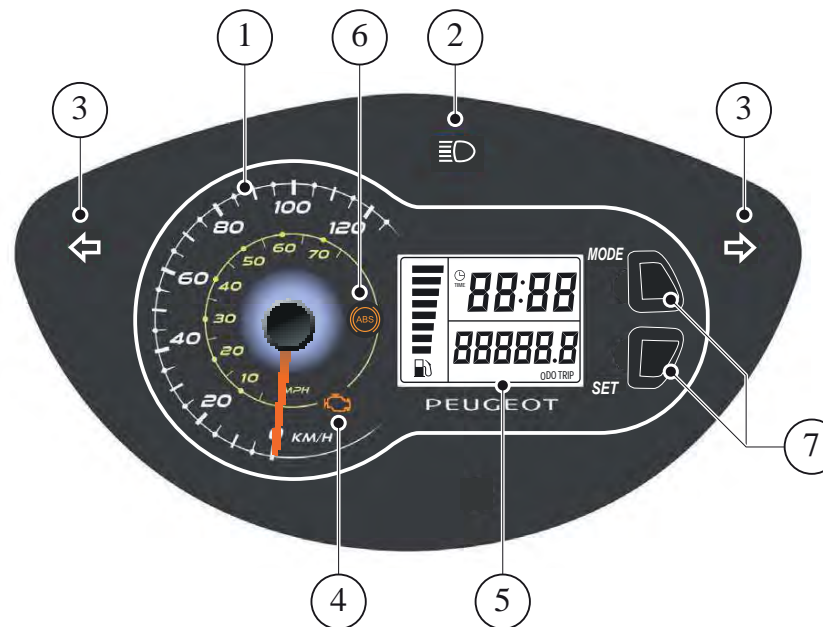
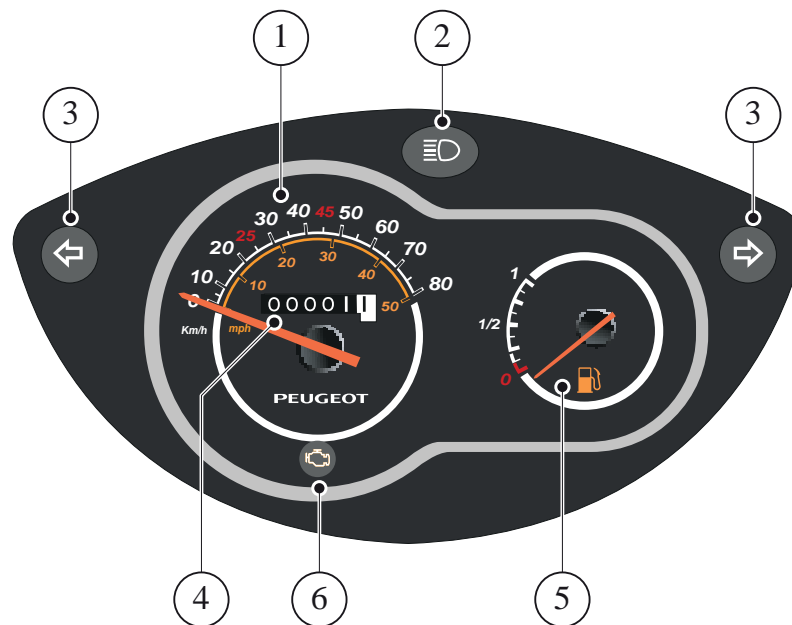

1. Depending on model

MULTI-FUNCTION DISPLAY

A. Milometer

The tripmeter displays and stores the number of kilometres travelled by the vehicle. The machine total kilometres remains in the memory when the battery is disconnected.

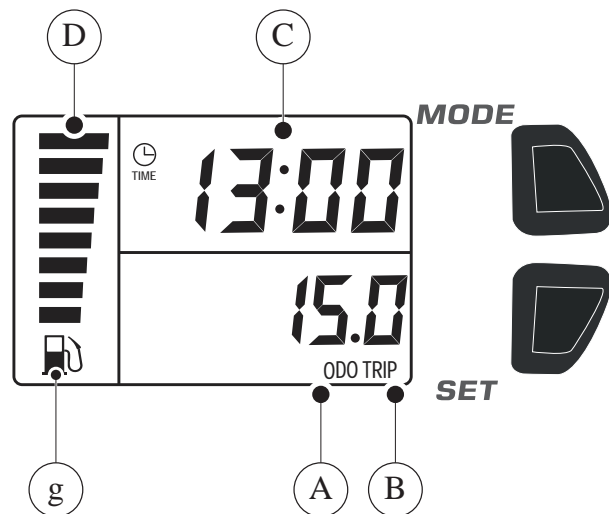

B. Tripmeter (TRIP)

The tripmeter displays and stores the number of kilometers travelled during a given period.

Changing from the total distance display to the daily distance display

- With the ignition on, changeover from the total distance to the daily distance display and inversely is by briefly pressing the control button (MODE).

Resetting the tripmeter

Resetting the tripmeter is done from the TRIP position.

- The daily counter is reset by a short press on the control button with the ignition on (SET).

C. Setting the clock

It is only possible to set the time in the total kilometres position with the machine stationary.

- Turn on the ignition and set the clock.
- Press the control button (several times briefly) until the figures of the clock flash (SET).
- Set the time by successive pushes on the control button (MODE).

A short press on the control button makes the first minutes figure flash (SET).

- Change the minutes by successive pushes on the control button (MODE).

A short press on the control button makes the second minutes figure flash (SET).

- Change the minutes by successive pushes on the control button (MODE).

Pressing the control button allows you to validate the value (SET).

D. Fuel gauge. Fuel reserve gauge.

When the tank is full:

- All of the fuel level indicator segments are lit.

When the tank is empty, the last segment on the fuel level indicator and the pump symbol flash (g).

CONTROLS

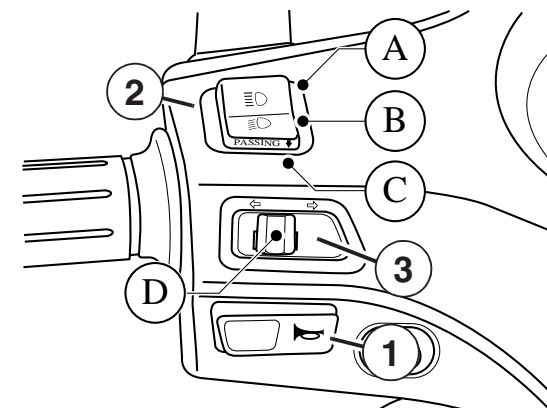

1. Horn switch

2. Dipped lights/Headlights switch

The dipped lights/headlights switch has 3 functions:

- A. High beam
- B. Dip beam
- C. Flashing the lights/Opening of the saddle¹

3. Indicators switch

To indicate a change of direction, press the switch (D):

- Either to the right.
- Or to the left.

To stop the indicators flashing, press the switch (D).

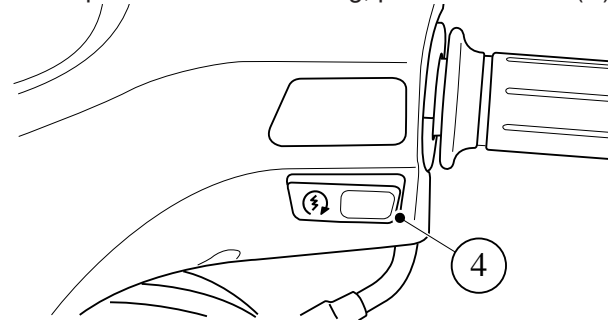

4. Starter switch

¹ Depending on model

KEY-OPERATED IGNITION SWITCH FUNCTIONS

A. Engine off position

The engine is off. Power to the electrical circuit is off. The key can be removed.

B. On position

Power to the electrical circuit is on. The engine can be started. The key cannot be removed.

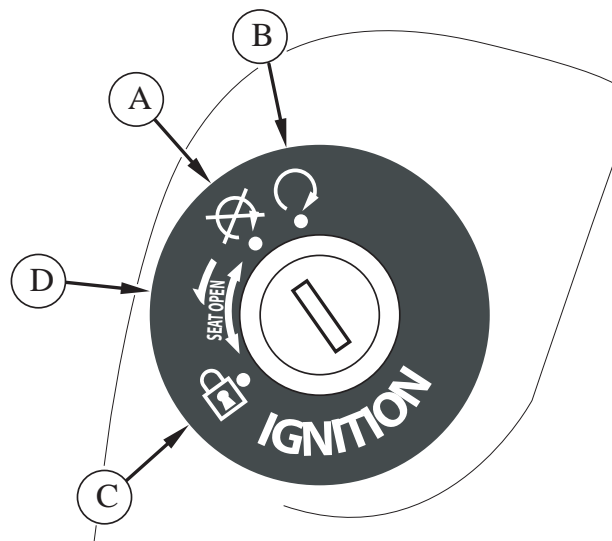

C. Steering unlocked

Power to the electrical circuit is off. The handlebars must be turned to the left, while the key must be simultaneously pushed in and turned to the left. The key can be removed.

D. Opening the saddle

Action of the key in this position allows you to open the saddle with a cable device.

EQUIPMENTS

Circuit breaker¹

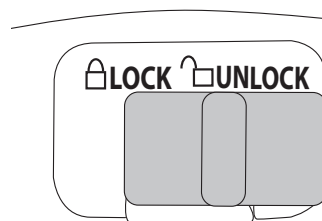

A switch neutralising the ignition circuit is located in the compartment under the saddle.

LOCK position. The engine shall not start.
UNLOCK position. The engine can be started.

Adjustment of damper settings

Each damper has an adjuster ring that can be used to stiffen or soften the suspension, depending on the vehicle load.

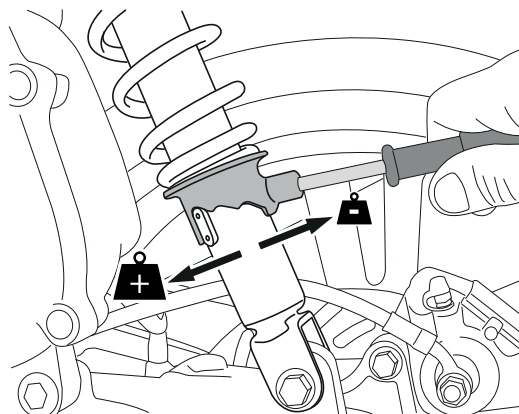

Use the on-board tool to make this adjustment.



To guarantee your comfort and safety, always adjust the damper preload in line with the vehicle load.

125/200 cc: Perform the same setting for the 2 dampers.

UTILITY HANGER

The utility hanger is located on the rear shield panel. It can be used to attach a maximum load of 2.5 kg.

LATERAL STAND

The lateral kickstand is fitted with an ignition cut-out which prevents the engine from being started while the stand is down.

This system reminds the driver to lift the stand before starting the engine.

If the engine starts with the kickstand down, it is essential to have the circuit checked by an approved dealer.

1. Depending on model

CHECKS TO PERFORM BEFORE USE

The user must personally ensure that his vehicle is in good condition. Certain safety elements may show signs of damage even when the vehicle is not used. e.g. prolonged exposure to bad weather can lead to oxidation in the braking system or a pressure drop in the tyres which can have serious consequences. In addition to a simple visual inspection, it is extremely important to check the following points before use.



These checks only take a few minutes and help to keep your vehicle in good condition, for optimum use combining reliability and safety.

If one of the elements in the checklist does not work properly, ask your registered dealer to check it and have it repaired if necessary before using the vehicle.

ADVICE FOR STARTING UP AND DRIVING

WARNING

Before using the vehicle for the first time, make sure you are familiar with all the controls and their respective uses. If you are not sure about the functions of any of the controls, your registered dealer can answer your questions and give you any help you may require.



As exhaust fumes are toxic, the engine must be started in a well-ventilated area. It must never be allowed to run in a closed space, even for a short time.

ECO MODE

Adopt smooth driving behaviour

- Turn the acceleration handle gradually, not suddenly.
- Anticipate braking using the engine brake.
- Limit the vehicle load as well as aerodynamic resistance.
- Regularly check the inflation pressure in your tyres, and refer to the label under the seat.
- Avoid heating up the engine while stationary: the engine heats quicker when you drive.
- Have your vehicle serviced according to the manufacturer's maintenance plan.

These attitudes contribute to economising fuel consumption, reducing CO2 emissions and alleviating the background sound of traffic.

DRIVING ON FLOODED ROADS



You are strongly advised not to drive on flooded roads as this may seriously damage the engine, transmission and electrical systems on your vehicle.

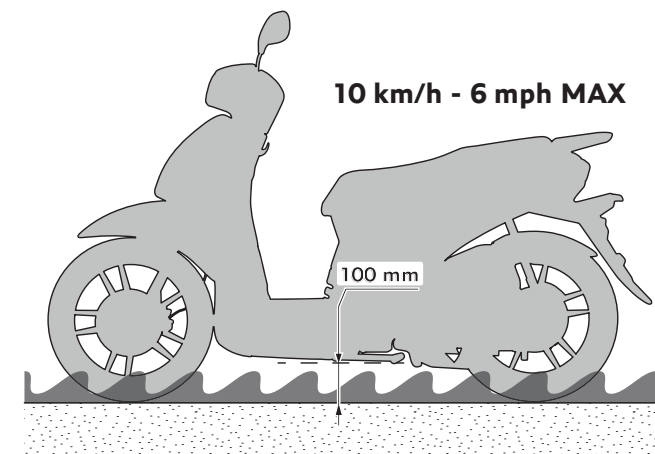

If you cannot avoid driving through flood water:

- Check that the water depth does not exceed 100, taking into account waves which could be generated by other road users.
- Under no circumstances exceed a speed of 10 km/h.
- Once out of the flooded area, brake gently several times to dry out the brakes as soon as the safety conditions allow it.

GB

INSPECTION BEFORE SETTING OFF

Component	Checks
Fuel	<ul style="list-style-type: none">• Check the fuel level in the tank.• Top up with fuel if necessary.• Check that there is no fuel leak.
Engine oil	<ul style="list-style-type: none">• Check the level of the engine oil.• If necessary, top up with the recommended oil.
Disk brakes	<ul style="list-style-type: none">• Check brake operation.• Have an approved dealer check them if they feel soft.• Check brake pad wear.• Check the level of brake fluid in the reservoir.
Drum brakes ^a	<ul style="list-style-type: none">• Check brake operation.• If necessary adjust the control.• Check the wear on the brake linings.• Correct if necessary.
Lighting, signalling, indicators, horn	<ul style="list-style-type: none">• Check operation.• Correct if necessary.

a. Depending on model

Wheels and tyres	<ul style="list-style-type: none">• Check the tyre wear and condition.• Check the tyre pressures cold.• Correct if necessary.
Throttle	<ul style="list-style-type: none">• Check the throttle handle turns smoothly and returns correctly to its starting position.
Steering	<ul style="list-style-type: none">• Check the free rotation of the steering.
Stand	<ul style="list-style-type: none">• Check that the central and side stands can be unfolded smoothly.• Operation of the ignition cut-out.

STARTING THE ENGINE

For greater safety, place the vehicle on its central stand before starting the engine.



Ensure that the switch under the saddle is in position **UNLOCK**.

- Turn the ignition key to "ON".
- Ensure that the throttle is in the OFF position.
- Press one of the brake levers while pressing the starter button. Do not press the starter for more than 10 seconds.
- Release the starter button as soon as the engine starts.



If the engine does not start, release the starter button and the brake lever, wait a few seconds and try again.

DRIVING

Starting off

The vehicle is on its stand with the engine running.

- Squeeze the brake lever with your left hand, grip the grab handle with your right hand and push the vehicle forwards to fold up the central stand.
- Sit on the vehicle.
- Release the left brake and turn the throttle slowly with your right hand to start moving.

Accelerating and decelerating

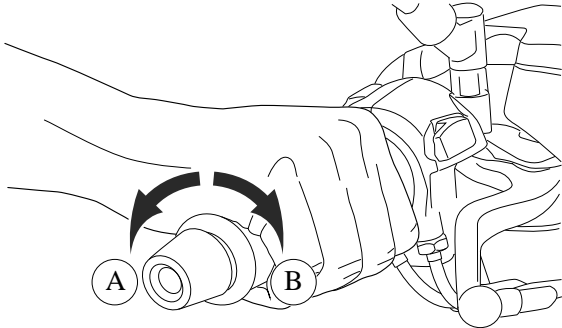

To accelerate, turn the throttle towards (A). To slow down, turn the throttle towards (B).

BRAKING

TWEET 50 cc

Conventional braking

The right lever controls the front brake and the left lever controls the rear brake

Use of the brakes

For good braking, it is very important to coordinate the following actions:

- Close the throttle.
- Operate the left and right brake levers simultaneously and slowly increase the pressure.



Using only one brake reduces braking efficiency and can lock the wheel, causing a fall

Avoid braking suddenly on wet roads or in bends.

Reduce speed on steep slopes to avoid prolonged braking, as overheating will reduce braking efficiency.

TWEET 125 cc

Braking system SBC

This is an integrated braking system.

- This system makes the vehicle easier to use: the right hand operates the throttle and the left hand controls the brake. When braking with the left hand, the system acts simultaneously on the front and rear brake.
- The right brake is a secondary service brake which only acts on the front brake and supplements the combined system on the left lever in case of emergency.

TWEET 200 cc

Braking system ABS

This is a wheel anti-lock system.

- Controlled by the right lever, it acts on the front wheel.
- The ABS system enables the rider to retain control of the vehicle when braking in slippery conditions.
- The left brake lever operates like a standard braking system by acting on the rear wheel.

Use of the brakes

- Close the throttle.
- Activate the brake system by gradually increasing the pressure.



Avoid braking suddenly on wet roads or in bends.

Reduce speed on steep slopes to avoid prolonged braking, as overheating will reduce braking efficiency.

FUEL-FUEL SAVING



The fuel tank should only be filled when the engine is completely off and avoiding overflowing. Any overflows must be wiped up immediately.

Fuel dilates when it heats up and may leak from the tank under the heat of the engine or the sun.

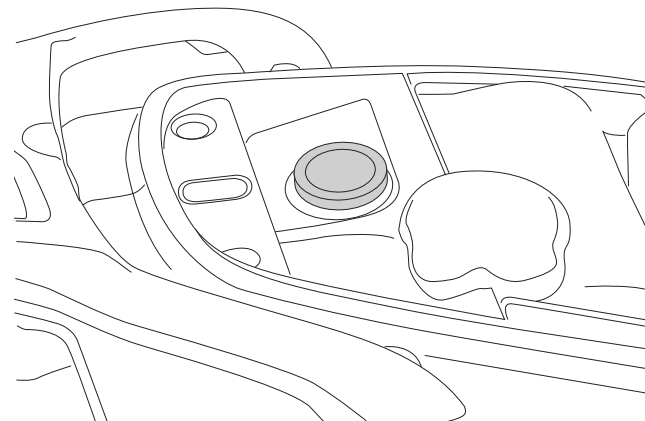

The fuel tank is located under the saddle.

When filling up with fuel, ensure the end of the nozzle is correctly inserted into the filling orifice on the fuel tank.

To reduce fuel consumption and protect your vehicle's mechanics.

- Avoid using very high revs over very short distances.
- Do not race the engine when declutched.
- Ensure that the weight of the user, the passenger, luggage and accessories does not exceed the maximum authorised load.
- Switch off the engine, even during a short halt.

Managing fuel consumption is also a way of personally contributing to environmental protection.

GB

RUNNING IN THE ENGINE

Running in the engine is essential to guarantee its performance and lifetime.

During the running-in period, you are advised not to overload the engine and to avoid exceeding a higher than normal operating temperature.

From 0 to 500 km.

Do not hold the throttle handle open at more than half its distance of travel over a long trip.

From 500 to 1000 km.

Do not hold the throttle handle open at more than 3/4 its distance of travel over a long trip.

Once this mileage has been done, the vehicle can be used normally.

SWITCHING OFF THE ENGINE AND PARKING

The engine is switched off when at idling speed by turning the ignition key to "OFF".

The vehicle should be parked on flat ground.

- Either on the middle stand.
- Or on the lateral stand.

Each time the vehicle is parked, the steering should be locked and the ignition key removed. The ignition circuit can be neutralised by setting the switch under the saddle to LOCK.

SERVICE OPERATIONS

MAINTENANCE ADVICE

Ensure that the servicing schedule for your vehicle is strictly followed to maintain your contractual warranty rights.

A table of inspections for the maintenance schedule is inserted into the maintenance booklet. The registered dealer must add his stamp, the date of servicing and the number of kilometres the vehicle has covered.

In order to maintain maximum safety and reliability of your vehicle, you are advised to have maintenance and repairs carried out by a registered dealer who has the necessary technical training, specific tools and spare parts.

ENVIRONMENT / RECYCLABLE

Worn parts replaced during routine maintenance (mechanical parts, battery, etc.) must be disposed of with specialised bodies.

At the end of its life, the vehicle must be taken to an authorised centre for recycling.

In all cases, comply with the local laws.



Batteries contain harmful substances. They must be disposed of according to the legal requirements and must under no circumstances be thrown away in the household waste.

CLEANING THE VEHICLE



The bodywork is made of plastic parts that can be painted or are shiny. Do not use solvents or cleaning products that are too corrosive.

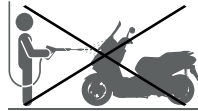

Do not use high pressure cleaners which may cause water to infiltrate the following parts: seals, bearings and hinges, electrical components such as connectors, contactors and lighting.

Wash the bodywork with soapy water and rinse with generous amounts of clear water.

The vehicle can be dried with a chamois leather. After washing the vehicle, brake several times at low speed to dry out the brakes.



The vehicle should be washed in a place equipped for wastewater collection.

Certain silicon-based products can alter the quality of the paintwork. In case of need or doubt, a registered dealer can advise you on using cleaning products or restoring scratched bodywork.

SPARK PLUG INSPECTION OR REPLACEMENT



It is essential to use a resistive spark suppressor and a resistive spark plug in accordance with the manufacturer's recommendations.

The engine must be cold.

- Remove the spark plug access hatch.
- Remove the saddle storage compartment.
- Disconnect the suppressor.
- Remove the spark plug.
- Measure the distance between the electrodes and correct it if necessary (A).

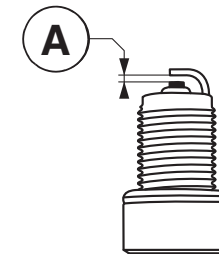

Electrode gap

0.7 to 0.8 mm

Spark plug

50 cc	NGK CR6HSA
125/200 cc	NGK CR7HSA

- Fit and screw in the spark plug manually.
- Tighten the spark plug with a spanner.
 - 1/8 - 1/4 turn for a reused spark plug.
 - 1/2 turn for a new spark plug.



Ensure the suppressor is correctly clipped onto the spark plug. Have the torque quickly checked by a registered dealer.

GB

CHECKING THE ENGINE OIL LEVEL



Too much oil will noticeably restrict the vehicle's performance.

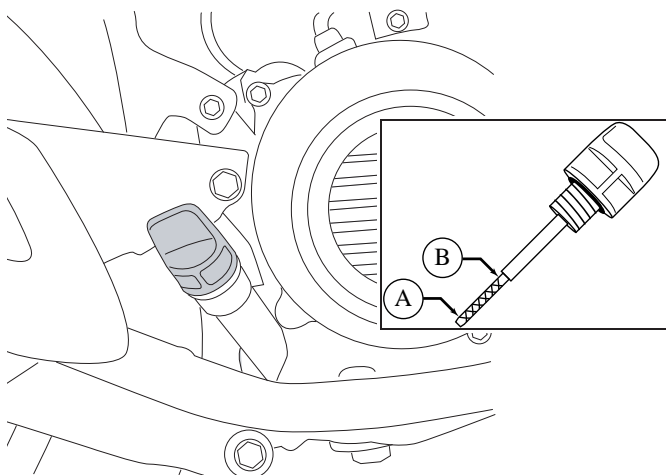

- Place the vehicle on its central stand on flat ground.
- Remove the engine's oil filler cap/gauge.
- **Wipe the cap/gauge and reinsert it into the filling orifice without screwing it up.**
- Remove the filler cap/gauge and check the oil level.
- The oil level shall not be between the minimum (A) and maximum (B) level marks without exceeding the latter.
- Add oil if necessary.

CHANGING THE ENGINE OIL



We advise you to go to a registered dealer for draining.



Oil contains substances which are harmful to the environment. Your dealer is equipped to dispose of used oil without endangering the environment and in compliance with current standards.

Engine oil	
50 cc	0.65 l at oil change
	SAE 10W30 Synthetic API SL/SJ SAE 5W40 Synthetic API SL/SJ SAE 15W50 Synthetic API SL/SJ
125/200 cc	0.7 l at oil change
	SAE 10W30 Synthetic API SL/SJ SAE 5W40 Synthetic API SL/SJ SAE 15W50 Synthetic API SL/SJ

When the ambient temperature is below -5 °C, use an oil of viscosity: 5W40

MULTIGRADE	5 W 40										
	10 W 30										
°C	15 W 50										
	-30	-20	-10	0	10	20	30	40			
°F	-22	-4	14	32	60	68	86	104			

The engine must be drained when it is warm to allow the oil to run easier.

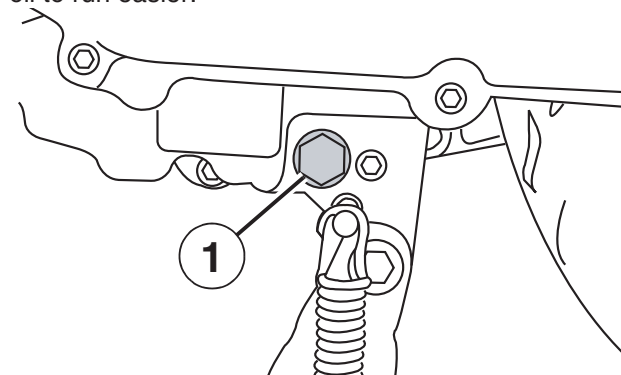

- Place the vehicle on its central stand on flat ground.
- Put on protective gloves.
- Remove the drainage cap and its seal (1) and allow the oil to drip into a recipient.

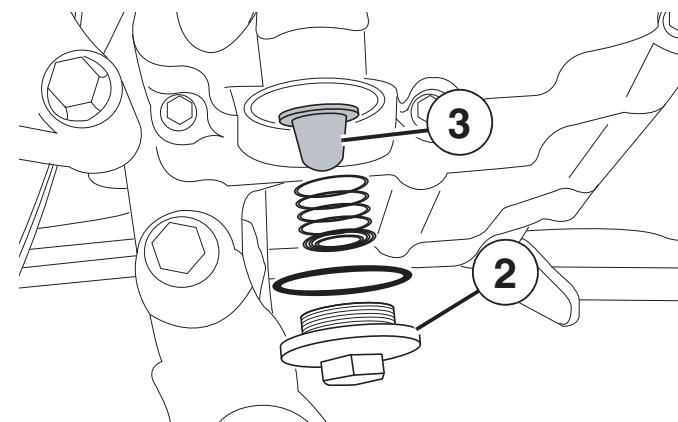

- Remove the strainer cap (2) and clean the strainer (3).
- Put back the drainage cap and strainer cap, fitted with a new seal.
- Pour the required quantity of oil corresponding to the manufacturer's standards into the filler hole.

- Start the engine and let it run for a short while.
- Add oil if necessary.
- Check that the oil drain plug is sealed.

DRAINING THE RELAY BOX



We advise you to go to a registered dealer for draining.



Oil contains substances which are harmful to the environment. Your dealer is equipped to dispose of used oil without endangering the environment and in compliance with current standards.

The gearbox must be drained when the engine is warm so that the oil will run easier.

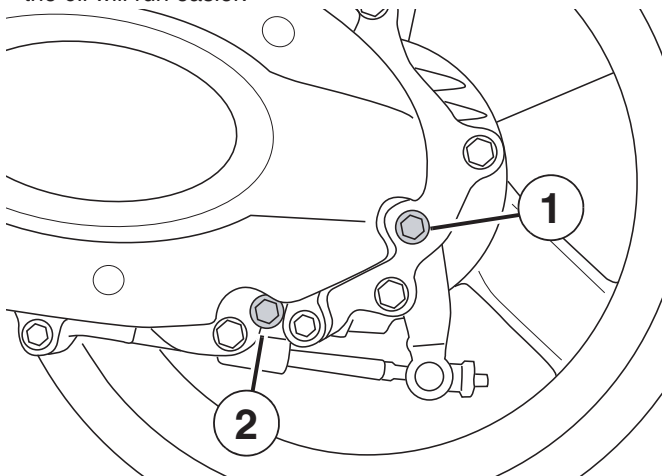

- Place the vehicle on its central stand on flat ground.
- Place a container under the drain port.
- Remove the relay box filler cap (1).
- Remove the drain plug (2).
- Re-install the plug with a new seal.
- Pour the required quantity of oil corresponding to the manufacturer's standards into the filler hole.
- Fit the filler cap.

Relay box

SAE 80W90 API GL5

Quantity

0.17 l at oil change

REPLACING THE AIR FILTER

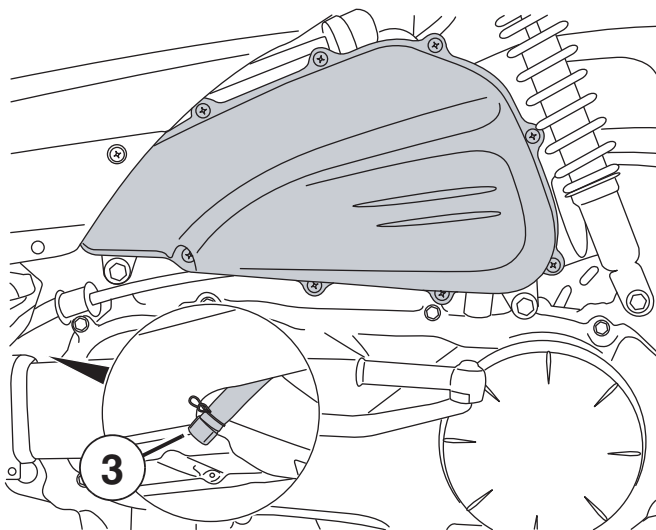

- Remove the air filter cover.
- Remove the air filter.
- Clean inside the air filter box.
- Fit a new air filter.
- Re-fit the cover.
- Remove the oil vapour return drain plug to let humidity and oil drip out (3).

THROTTLE CABLE PLAY

The play in the throttle control must be 3 to 5 mm on the handle (A).

If the play is incorrect, use the setting nut to adjust it (5).

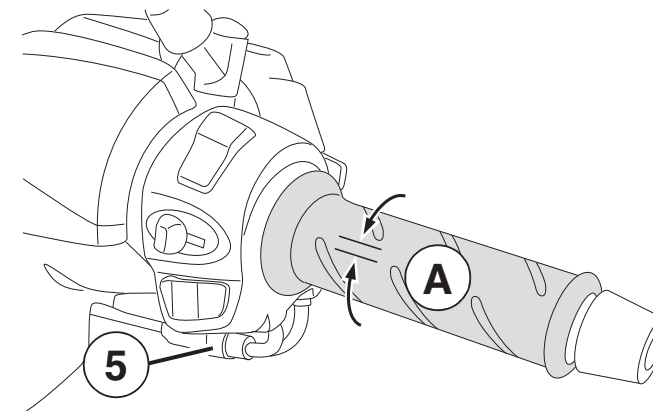

GB

TYRES

Tyre pressure should be cold-checked regularly.
Incorrect pressure causes abnormal wear and affects road behaviour, thus making driving dangerous.

Cold inflation pressure (bar)		
Front	Solo	1.75
	Pillion	2.0
Rear	Solo	2.0
	Pillion	2.25

If the wear limit on the tread is reached (B), you are advised to go to a registered dealer to change the tyres.

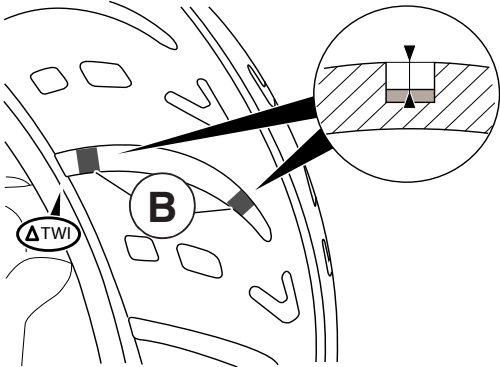

When replacing tyres, you are advised to mount tyres of the same brand and equivalent quality. In case of puncture, it is forbidden to mount an inner tube in a tubeless tyre.



Tyres contain substances that are harmful to the environment. Your dealer is equipped to dispose of used tyres without endangering the environment in compliance with current standards.

BRAKE INSPECTION



We advise you to go to a registered dealer for draining.

Front brake pad wear

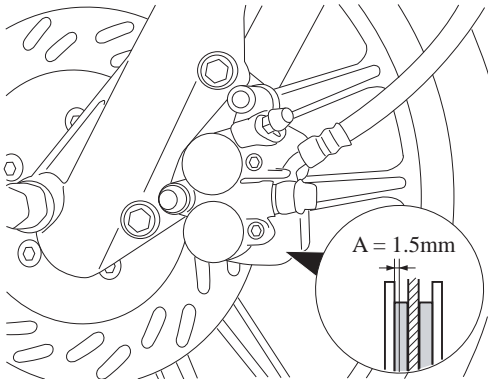

Rear brake pad wear

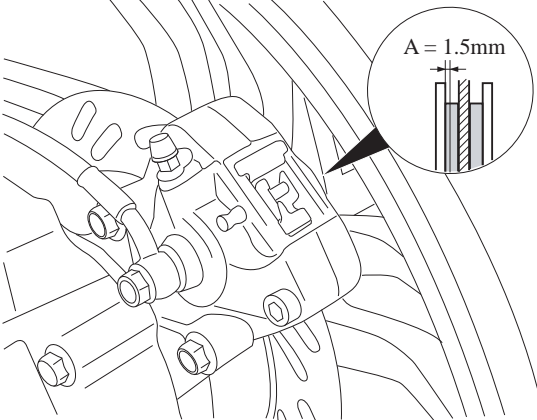

If one of the 2 brake pads is worn down to the minimum dimensions (A), the 2 brake pads must be changed.

Rear brake lining wear¹

When it is no longer possible to adjust the control tension nut, the brake pads are worn.

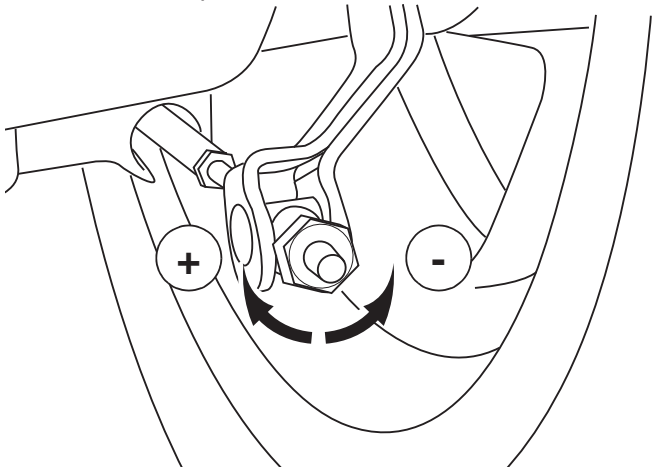

Actuate the brake control lever and check the position of the wear mark on the cam tierod (B) compared to the mark (C) on the engine housing.

If the cam tierod mark is aligned or with the wear mark or exceeds it, the brake linings must be changed.

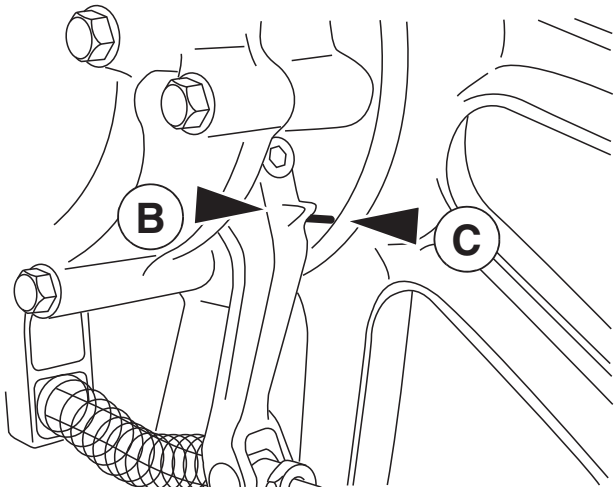

1. Depending on equipment.

BRAKE FLUID



The brake fluid levels must be checked regularly through the braking unit inspection window (A). If the level is close to the minimum mark, we advise you to go to a registered dealer to have the braking system checked and topped up if necessary.

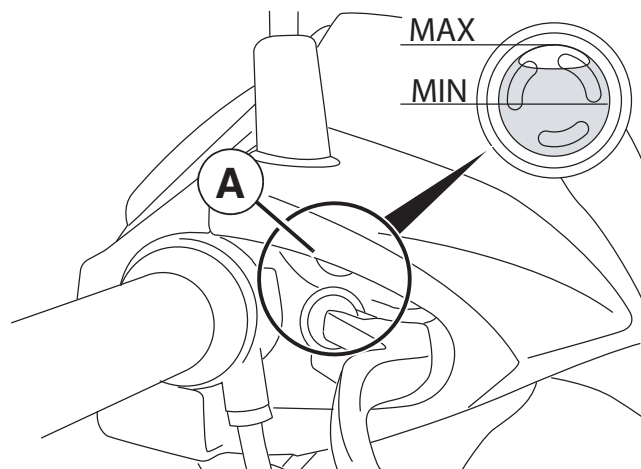

GB

BATTERY



Make sure you check that the battery is disconnected before performing any operations on it.

Battery power leads must never be disconnected while the engine is running.

To avoid damage to the electronic circuit, do not charge the battery if it is connected to the vehicle.



The sulphuric acid contained in the battery electrolyte can cause serious burns.

Avoid all contact with the skin, eyes or clothing and always protect your eyes when working near the battery.

In case of leakage, you are advised to consult a registered dealer who is equipped to replace and dispose of batteries without endangering nature and the environment.



A battery produces explosive gases.

Keep the battery away from sparks, flames, cigarettes, etc...

It should be charged in a well-ventilated area.

EXTENDED PERIODS OF IMMOBILISATION AND STORAGE



If the vehicle is not used for an extended period, the battery will slowly discharge naturally or due to its electronics or certain accessories and must thus be regularly charged.

If the vehicle is not used for a period of 1 month or longer, the battery charge must be preserved:

- Using a maintenance charger (if the vehicle is not used for a long period).
- If not, by disconnecting it from the vehicle (if the vehicle is not used for a period of less than 2 months).



If these recommendations are not followed, the battery may go into deep discharge. In this case the manufacturer's warranty will be void.

Removal of the battery

Remove the battery cover.

Disconnect the battery in the following order:

1. The negative terminal.
2. The positive terminal.

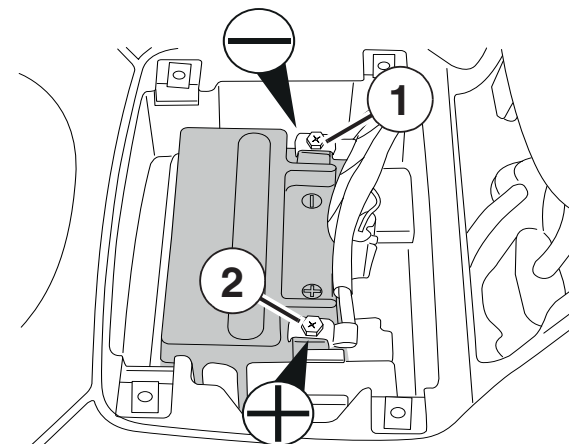

Battery charge

The battery must be charged in a well-ventilated area with a suitable charger that can feed a tenth of the battery capacity to avoid premature destruction. You are therefore advised to go to a registered dealer to carry out this operation.

Batteries contain sulphuric acid. Do not allow it to come into contact with skin or eyes. While the battery is charging, it can release explosive gases. Keep sources of sparks, flames and incandescent products away from it.

Maintenance-free batteries

A maintenance-free battery must never be opened for topping up.



A maintenance-free battery must never be opened for topping up.

- Disconnect and remove the battery.
- Charge the battery to 100% beforehand.
- Use a maintenance charger or charge monthly.
- Before restarting, the battery must be charged to 100%.

Installing the battery

Connect the batter in the following order:

1. The positive terminal.
2. The negative terminal.

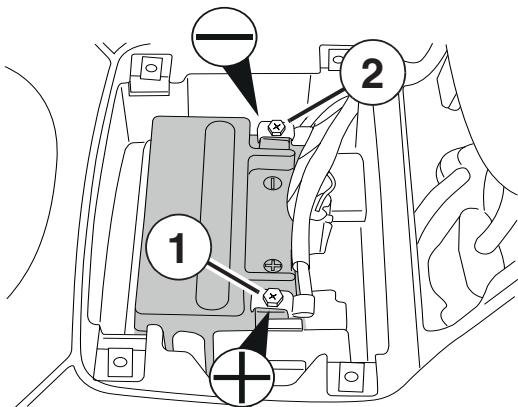

FUSES

The fuses are accessed by removing the saddle storage compartment.

Find the faulty fuse by looking at the condition of its filament.

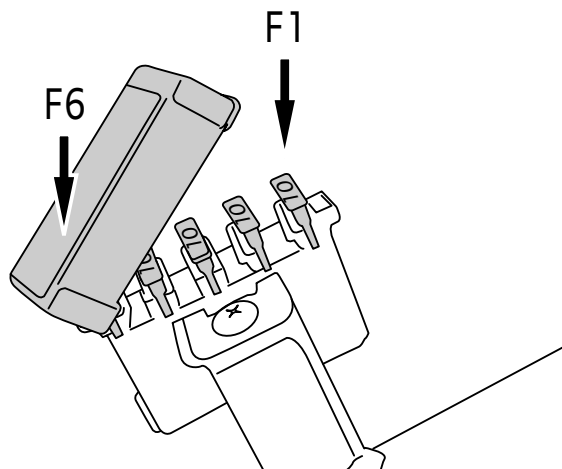
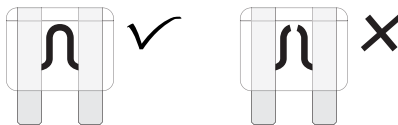

If a fuse often blows this is usually a sign of a short circuit in the electrical circuit. You are advised to have the system checked by a registered dealer.

Before changing a fuse, you must find the reason for the fault and correct it.

Always replace the faulty fuse with a fuse of the same rating.



You are advised to switch off the ignition before changing a fuse and always to replace it with a fuse of the same rating. If you do not do so, this may lead to damage in the electrical circuit or even a fire.

FUSE ALLOCATION

Fuse allocation			
TWEET 50cc TWEET 125 SBC		TWEET 200ABS	
F1 20A	Main fuse	F1 25A	ABS System
F2 15A	Injection system	F2 20A	Main fuse
F3 10A	+ after the ignition	F3 15A	Injection system
F4	Free	F4 10A	+ after the ignition
		F5 15A	Lighting
		F6	Free

GB

BULB REPLACEMENT

Headlight bulb

- Remove the rearview mirrors.
- Remove the headlight fairing (1).



You are advised to contact a registered dealer to have this operation carried out.

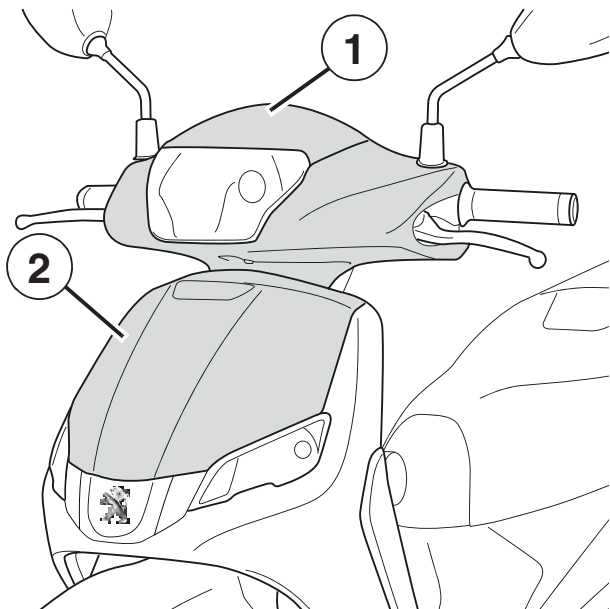

Indicator bulbs

- Remove the front upper shield panel (2).



You are advised to contact a registered dealer to have this operation carried out.

Rear light and indicator bulbs

- Remove the lamp lens (3).

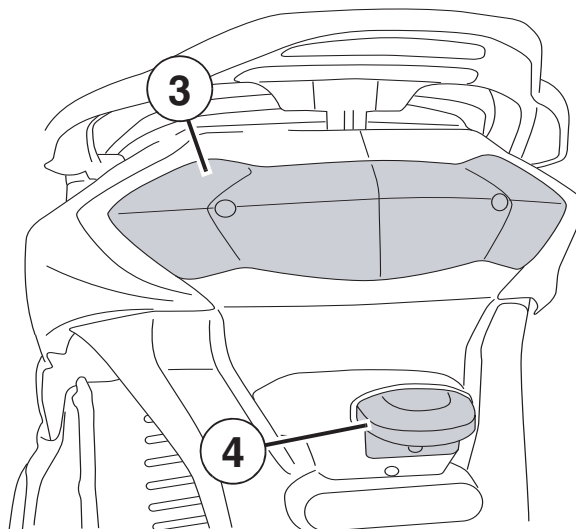

Number plate light bulb

- Remove the lamp lens (4).

HEADLIGHT HEIGHT ADJUSTMENT

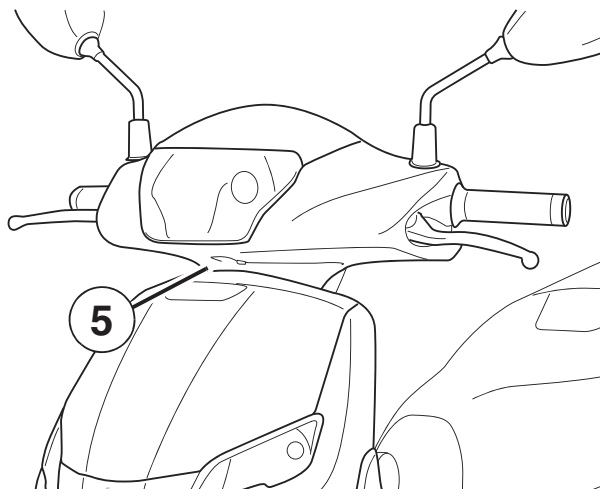

- Loosen the attachment screw (5).
- Adjust the direction of the headlamp by hand.
- Tighten the fastening screw.



**ISO 9001 (Édition 2008) /
N°SQ/1956**

**Peugeot Motocycles SA
Rue du 17 Novembre
F-25350 Mandeure**

Tél. +33(0)3 81 36 80 00 Fax
+33(0)3 81 36 80 80

RCS Belfort B 875 550 667

**www.peugeot-motocycles.fr
www.peugeot-motocycles.com**

0 800 007 216

**Service & appel
gratuits**

Dans un souci constant d'amélioration Peugeot Motocycles se réserve le droit de supprimer, modifier, ou ajouter toutes références citées.
DQ/APV du 6/2020 (photos non contractuelles).



PEUGEOT

MOTOCYCLES



Guide d'utilisation en ligne
Online user's guide

i-Connect® : application Peugeot Motocycles disponible sur
i-Connect® : Peugeot Motocycles app available on

