

PEUGEOT
MOTOCYCLES



PEUGEOT
MOTOCYCLES

DJANGO

Notice d'utilisation

User's manual



Notice d'utilisation

FR

Owner's manual

GB

Bedienungsanleitung

DE

Libretto d'istruzioni

IT

Manual de utilización

ES

Gebruikershandleiding

NL

ΕΓΧΕΙΡΙΔΙΟ ΧΡΗΣΗΣ

GR

Instruktionsbok

SE

Manual de proprietário

PT

Käyttöohjekirja

FI

Instruktionsbog

DK

CONTENTS

Information	2	Service operations	21
Safety advice	2	Maintenance advice.....	21
Characteristics	3	Environment / Recyclable	21
Vehicle identification	7	Cleaning the vehicle	21
Products to use	7	Spark plug inspection or replacement	21
Information about the instructions	8	Engine oil level.....	22
Description of the vehicle	9	Changing the engine oil.....	22
Instruments	10	Draining the relay box.....	23
Display functions	11	Replacing the air filter.....	23
Controls	13	Throttle cable play	23
Key-operated ignition switch functions	13	Tyres	24
Equipments	14	Brake inspection	24
Storage compartment / Accessory socket.....	14	Battery	25
Utility hanger	14	Fuses	26
Lateral stand.....	14	Bulb replacement	27
Accessory	15	Headlight adjustment	27
Front luggage carrier	15		
rear luggage carrier	15		
Top case	15		
Checks to perform before use	17		
Advice for starting up and driving	17		
Warning	17		
Eco mode	17		
Driving on flooded roads	17		
Inspection before setting off	18		
Starting the engine	18		
Driving	18		
Braking	19		
Fuel supply	20		
Running in the engine	20		
Switching off the engine and parking	20		

GB

INFORMATION

You have just bought a Peugeot vehicle.

We would like to thank you for purchasing one of our products.

Please take some time to read this manual carefully before using the vehicle.

This user manual should always be kept in the boot of the vehicle. It contains instructions for use, checks and maintenance of the vehicle, and important safety instructions intended to protect the user and third parties against accidents.

It will give you plenty of advice on how to keep your vehicle in full working order.

Your authorised dealer is familiar with all the vehicle's characteristics and has genuine spare parts and specific tools. He can advise you and service your vehicle in the best conditions according to the established service schedule to ensure that you can enjoy driving it in complete safety.

This manual must be considered as an integral part of the vehicle and must remain with it even if the vehicle is sold on.

PEUGEOT MOTOCYCLES is constantly improving its vehicles. It therefore reserves the right to remove, modify or add any reference mentioned.

SAFETY ADVICE

A inexperienced motorcyclist should make himself completely familiar with his vehicle before going out in traffic. You are strongly advised not to lend your vehicle to an inexperienced rider.

To ride a motorbike, you are required by law to hold a licence or to have completed specific training with a professional, depending on the applicable legislation and based on its category.

Wearing an approved helmet and gloves is obligatory for the user and passenger. You are also advised to wear goggles and light-coloured or reflective clothing adapted to motorcycling.

In some countries, the applicable legislation may not authorise transportation of a passenger, and elsewhere it may oblige motorcycle users to contract a civil liability insurance policy to protect third parties and the passenger against potential damage resulting from an accident.

Driving whilst under the influence of alcohol, drugs or certain medicines is inexcusable and dangerous for yourself and others.

Excessive speed is an important factor in many accidents. You must observe the road signs and signals and adapt your speed to the weather conditions.

The engine and the exhaust system components can reach very high temperatures. When parking your vehicle, be careful to avoid contact with inflammable materials which could cause a fire or with parts of the body which could result in serious burns.

Luggage carriers and paniers approved by PEUGEOT MOTOCYCLES are available as options (depending on the model). The assembly instructions must be complied with and the maximum permissible load (3 to 5 kg depending on the equipment) must not be exceeded.

Fitting accessories such as the driver's apron, top-case, etc. may affect the vehicle's stability (wind factor, load, etc.).

When riding the vehicle fitted with accessories, the driver should reduce speed.

Mounting adaptable parts that have not been approved by PEUGEOT MOTOCYCLES, which alter the technical characteristics or performances of the vehicle is forbidden. Any modification will invalidate the warranty and the vehicle will no longer be in compliance with the version approved by the appropriate services.

CHARACTERISTICS

	DJANGO 50 45 km/h	DJANGO 50 25 km/h	DJANGO 125 ABS
Official type-approval code.	M1ADKC	M1AEKC	M2AALB
Weight in kg			
Unladen weight.	118	129	
In working order.	126	135	
Authorised maximum. Total weight of the vehicle, the user, the passenger, the accessories and luggage.	310	330	

Dimensions in mm

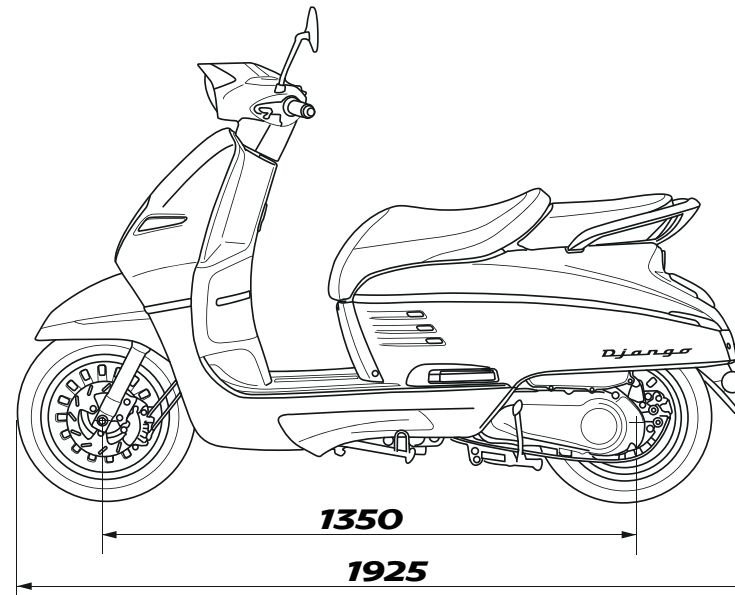
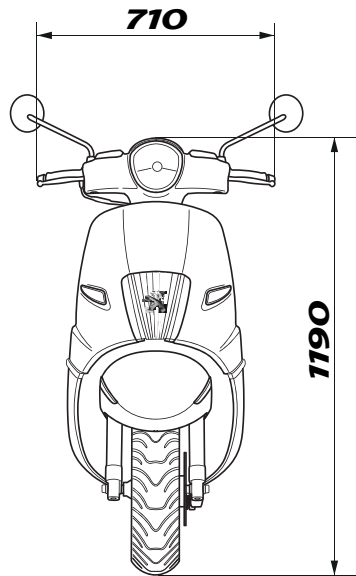

GB

CHARACTERISTICS

	DJANGO 50 45 km/h	DJANGO 50 25 km/h	DJANGO 125 ABS
Official type-approval code.	M1ADKC	M1AEKC	M2AALB
Engine			
Identification.	139QMB-K		P1P52QMI-3G
Engine type.	4-stroke single-cylinder		
Cubic capacity.	50 cc		125 cc
Bore x stroke	39 x 41.4 mm		52.4 x 57.8 mm
Maximum power.	2.6 kW at 7700 rpm		7.8 kW at 8000 rpm
Maximum torque.	3.2 Nm at 7300 rpm		9.3 Nm at 6500 rpm
Cooling.	Air cooling		
Fuel supply.	Indirect electronic injection (EFI)		
Spark plug.	NGK CR7HSA		
Lubrication.	Pressurised wet sump lubrication		
Exhaust.	Catalysed and lambda sensor		
Anti-pollution standard.	Euro 5		
Consumption ^a .	1.9 l/100	2.8 l/100	2.3 l/100
CO ₂ emission (On cycle).	45 g/km	65 g/km	52 g/km
Capacities in litres			
Engine oil. - Changing the engine oil.	0.8 0.65 l at oil change		0.95 0.75 l at oil change
Relay box oil.	0.12		0.18
Fuel tank.	8.5		8.5
Fork oil.	0.09		0.09

a. These consumption values are established according to the regulation 134/2014 Annexe VII. They may vary according to driving behaviour, traffic conditions, weather conditions, the load in the vehicle, vehicle maintenance and use of the accessories...

CHARACTERISTICS

		DJANGO 50 45 km/h	DJANGO 50 25 km/h	DJANGO 125 ABS
Official type-approval code.		M1ADKC	M1AEKC	M2AALB
Tyre dimensions				
Front.		120/70 - 12		120/70 - 12
Standard load index and speed rating.		58L		58L
Minimum load index and speed rating.		40B		40G
Rear.		120/70 - 12		120/70 - 12
Standard load index and speed rating.		58L		58L
Minimum load index and speed rating.		58B		58G
Pressure in bars				
Front.	Solo.	1.8		1.8
	Pillion.	1.8		1.8
Rear.	Solo.	2		2
	Pillion.	2.2		2.2
Suspension				
Front.		Ø32 mm telescopic fork Travel: 85 mm		Ø32 mm telescopic fork Travel: 85 mm
Rear.		1 Shock absorber Travel: 80 mm		1 Shock absorber Travel: 88 mm
Brakes				
Front.		1 Ø200 mm disk		1 Ø200 mm disk
Rear.		1 drum Ø110 mm		1 Ø190 mm disk

GB

CHARACTERISTICS

	DJANGO 50 45 km/h	DJANGO 50 25 km/h	DJANGO 125 ABS
Official type-approval code.	M1ADKC	M1AEKC	M2AALB
Electrical equipment			
Headlights.	12V - 35/35W (HS1)		12V - 60/55W (H4)
"Side light" bulbs.	12V - 5W or LED		12V - 5W or LED
Indicator bulbs.	LED		LED
Rear light.	LED		LED
Number plate light.	12V - 5W		12V - 5W
Battery.	12V - 6Ah Maintenance-free batteries YUASA YTX7A-BS		12V - 8Ah Maintenance-free batteries YUASA BTZ10S-BS

VEHICLE IDENTIFICATION

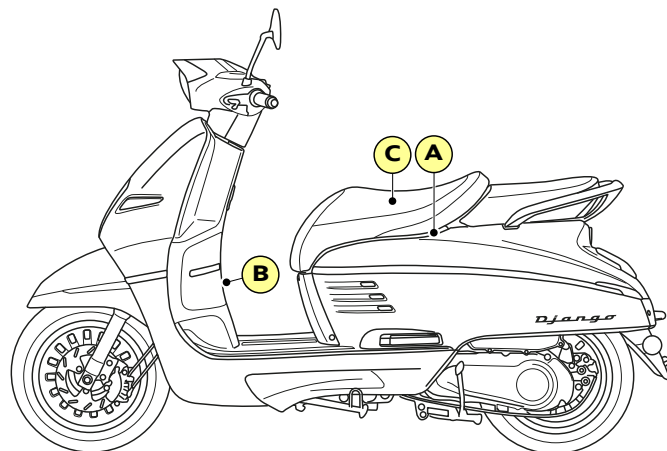

A. Manufacturer's plate.

B. Vehicle identification number (V.I.N.).

C. Tyre pressure label.

The label affixed under the saddle gives the cold tyre pressures when riding alone and with a passenger.



Temperature variations modify tyre pressure.

The tyre pressure must be checked once a month when cold.

PRODUCTS TO USE

Lead-free petrol

E5

E10

Bleifreies Benzin
Unleaded fuel only
Carburant sans plomb
Gasolina sin plomo
Bezolovnatý benzin
Endast blyfri bensin

RON/ROZ min. **95**

Engine oil

50 cc	SAE 5W40 Synthetic API SL/SJ
125 cc	SAE 10W40 / SAE 10W50 100% Synthetic Minimum grade API SL

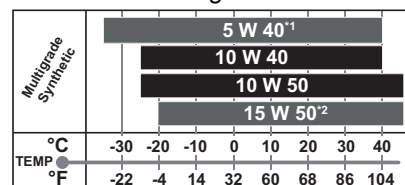

*Recommended if:

- ¹ Minimum annual temperature < -20°C
- ² Minimum annual temperature > 0°C

Relay box oil

SAE 80W90 API GL4

Brake fluid

DOT 4

Grease

High-temperature grease
Multi-use grease

Fork oil

Hydraulic oil 10W

INFORMATION ABOUT THE INSTRUCTIONS

Specific information is indicated by the following symbols:

GB



Möbius band

Recyclable.

Means that the product or the package can be recycled.



Explosive

The product may explode upon contact with a naked flame, spark or static electricity, or due to the effect of heat, an impact or friction.

Handle and keep away from heat sources and other causes of sparks.



Flammable

The product may ignite in contact with a naked flame, a spark or static electricity, or due to the effect of heat, friction, in contact with the air or in contact with water, releasing inflammable gases.

Handle and keep away from heat sources and other causes of sparks.



Corrosive

The product is corrosive.

It can attack (corrode) or destroy metals.

Contact with the product or splashes of the product may burn the skin and cause lesions to the eyes. Avoid any contact with the eyes and skin. Do not inhale.



Harmful to health

The product can be poisonous in high doses.

It may irritate the skin, eyes and airways.

It may cause skin allergies.

It may cause drowsiness or dizziness. Avoid all contact with the product.



Toxic or fatal

The product can rapidly be fatal.

It poisons rapidly, even at low doses. Wear protective equipment.

Avoid any contact (oral, skin, inhalation) with the product and wash all exposed areas carefully after use.



Harmful for the environment

The product pollutes.

It has a harmful effect (in the short and/or long term) on organisms in aquatic environments.

Do not dispose of it in the environment.



Do not throw away into a garbage can

One of the product's component is toxic and can be hazardous to environment. Do not throw the used product in the dustbin. Take it back to the trader or to a specific waste disposal site.



People's safety

Operation that can be dangerous for people.

People's safety can be seriously affected if the recommendations are not fully respected.



Important

Operation that can be hazardous to the vehicle.

Indicate the specific procedures that shall be followed in order not to damage the vehicle.



Note

Gives key information concerning operation of the vehicle.

DESCRIPTION OF THE VEHICLE

1. Instrument panel
2. Utility hanger
3. Lock (Fuel tank flap/Storage compartment)
4. Fuel tank
5. Rider saddle
6. Passenger backseat
7. Grab handle
8. Kick starter¹
9. Central stand
10. Folding passenger footrests
11. Lateral stand
12. Left brake lever
13. Brake fluid level
14. Right brake lever
15. Throttle
16. Ignition switch / Opening of the saddle
17. 12V accessory socket / USB socket¹
18. Engine oil level
19. Battery/Fuses
20. Saddle storage compartment

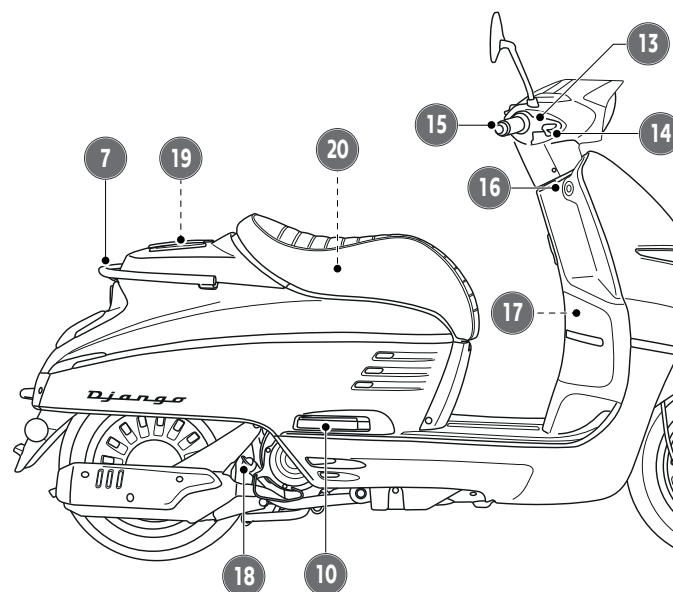
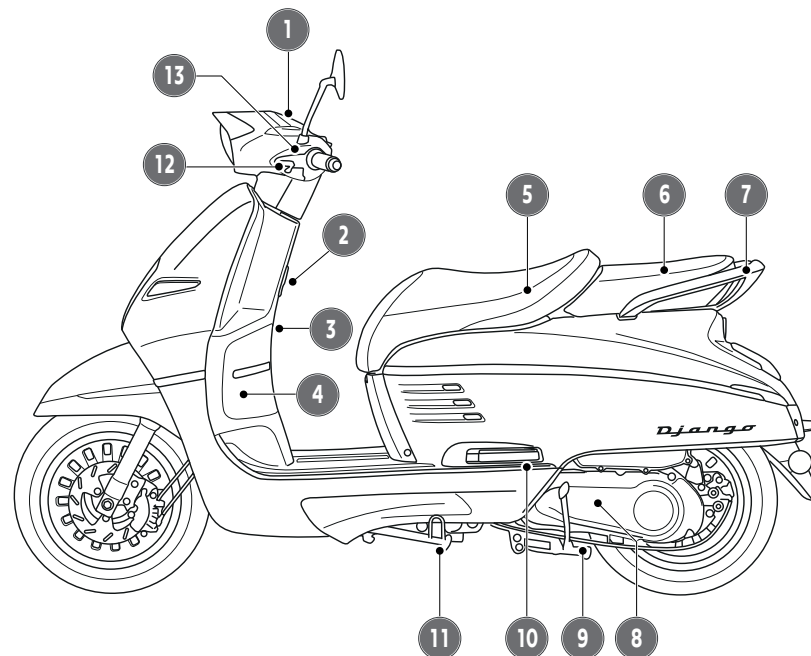

1. Depending on model

INSTRUMENTS

The instrument panel initializes itself every time the ignition is switched on: A function test of the display unit segments and lighting of all indicator lights are performed automatically.

Instrument panel 50 cc

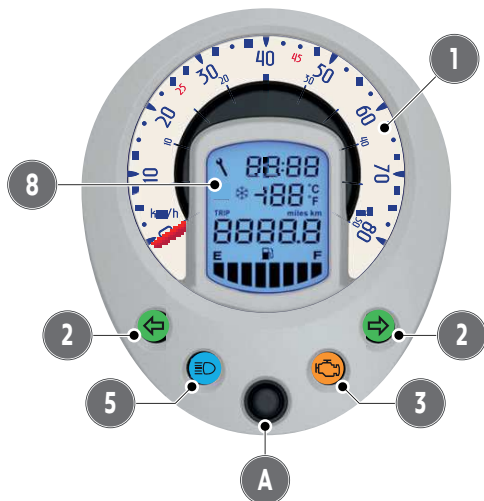

Instrument panel 125 cc ABS

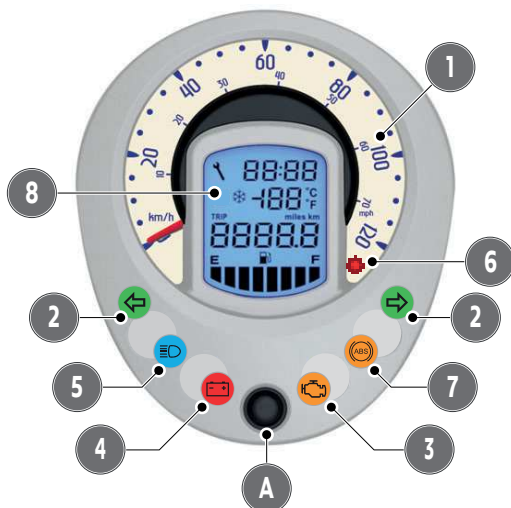

1. Speedometer

- Double-scale speedometer showing kilometers and miles.

2. Right-Left indicator warning light/Hazard warning light indicator

- The instrument panel is equipped with one indicator warning light per side.
- A buzzer reminds the driver of the direction indicators.



If the warning light flashes quickly, there is a fault in the direction indicators.

- The hazard warning lights can only be switched on with the ignition in the "ON" position.
- The hazard warning lights are automatically deactivated 1 hour after the ignition is switched off to save the battery.

3. Emissions control system failure warning light

- If the indicator light turns on when riding, you are advised to have the vehicle checked by an authorised dealer.

4. Battery charge indicator

- If the battery charge indicator flashes while driving, you are advised to have the battery charging system checked by an approved dealer.

5. Main beam control

6. Deterrence light

7. Brake system management indicator light ABS

If the indicator light turns on intermittently or remains on, you are advised to stop the vehicle and have it checked by an authorised dealer.



At very slow speeds and during shut-down, the lamp ABS blinks slowly, indicating that the system is deactivated.

If the battery charge indicator flashes when moving, you are advised to have the battery charge system checked by an approved dealer.

8. Multi-function display

A. Display control knob

DISPLAY FUNCTIONS

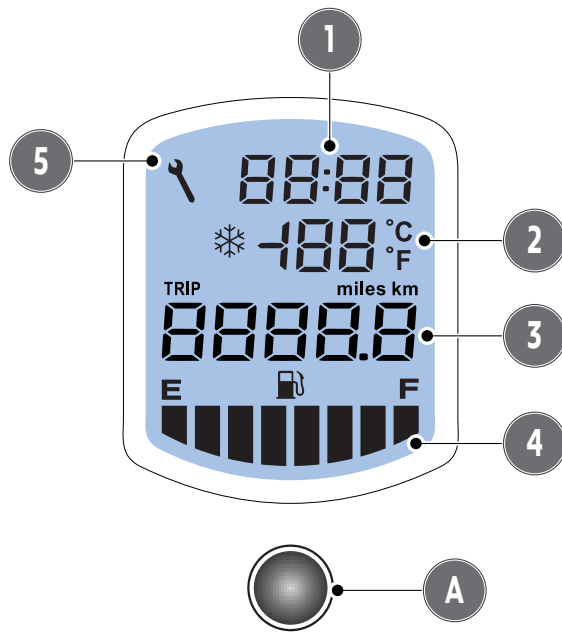

1. Clock.
2. Outside temperature gauge.
3. Milometer/Tripmeter.
4. Fuel gauge/Fuel reserve gauge.
5. Maintenance indicator.
- A. Display control knob.

1. Setting the clock

The counter must be on the total kilometers.

Ignition on, press the control button (A) until the time flashes.

- Set the time by successive pushes on the control button.

Pressing the control button for more than 2 seconds will make the first digit of the minutes flash.

- Change the minutes by successive pushes on the control button.

Pressing the control button for more than 2 seconds will make the second digit of the minutes flash.

- Change the minutes by successive pushes on the control button.

Press the control button for more than 2 seconds to confirm the clock setting.

2. Outside temperature gauge

- The temperature shown is that read on the front of the vehicle.
- The "risk of black ice" symbol comes on as soon as the temperature falls below 3°C.

3. Milometer

The tripmeter displays and stores the number of kilometres travelled by the vehicle. The machine total kilometres remains in the memory when the battery is disconnected.

Tripmeter (TRIP)

The tripmeter displays and stores the number of kilometres travelled during a given period. The vehicle's daily mileage remains stored, even when the battery is disconnected.

Changing from the total distance display to the daily distance display

- With the ignition on, switching from the total distance display to the daily tripmeter and vice-versa is done by briefly pressing the control button (A).

Resetting the tripmeter

- With the ignition on, resetting the daily tripmeter is done by pressing the control button (A) for more than (3) seconds.

4. Fuel gauge/Fuel reserve gauge

When the tank is full:

- All of the fuel level indicator segments are lit.
- The "pump" symbol is displayed.

The min. and max. levels are indicated by the letters E and F.

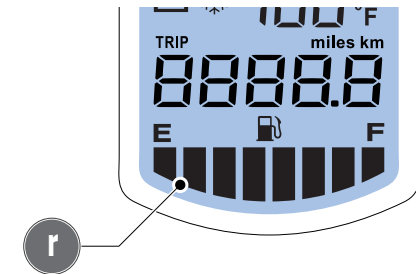

The fuel reserve gauge is shown by the last 2 segments flashing (r):

- 1st level: the first two segments flash.
- 2nd level: the first segment flashes.

When the tank is empty, all the segments on the fuel gauge are off and the "pump" symbol flashes.



If all the segments flash, the diagnostic function has detected an anomaly on the fuel gauge system. The system must be checked by an authorised dealer.

GB

5. Maintenance indicator

Each time the ignition is switched on, the display indicates the milage remaining before the next service.

Frequency displayed on the service indicator

5000 km

When the kilometres to maintenance reaches zero, the maintenance symbol remains lit on the display.



You are advised to go to an approved dealer to service the vehicle and erase the service symbol.

Maintenance counter reset

- Ignition off, hold down the control button (A) and turn on the ignition, the distance unit flashes.
- Release the settings button.
- Hold down the settings button for more than 5 seconds to switch off the maintenance symbol and set the maintenance counter to zero.
- Turn off the ignition.



You are advised to go to an authorised dealer to have the vehicle serviced and the message on the maintenance indicator erased.

Choosing the display units



Choosing the distance unit is possible at any time.



- With the ignition off, hold down the settings button (A), switch on the ignition and wait for the multifunction display to come on.
- Select the unit by briefly pressing the control button, the distance unit changes from "km" to "miles" or inversely.
- Turn off the ignition.



**If the distance unit is kilometres, the outside temperature is displayed in °C.
If the distance unit is miles, the outside temperature is displayed in °F**

CONTROLS

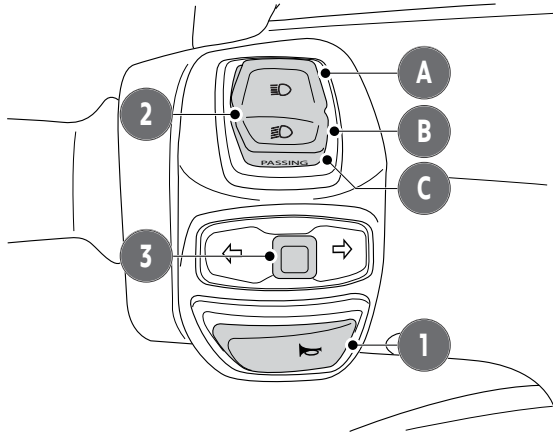

1. Horn switch.
 2. Dipped lights/Headlights switch.
- The dipped lights/headlights switch has 3 functions.

- A. High beam.
- B. Dip beam.
- C. Flashing the lights (Passing).

3. Indicators switch.
- To indicate a change of direction, press the switch:
- Either to the right.
 - Or to the left.
- To stop the indicators flashing, press the switch.

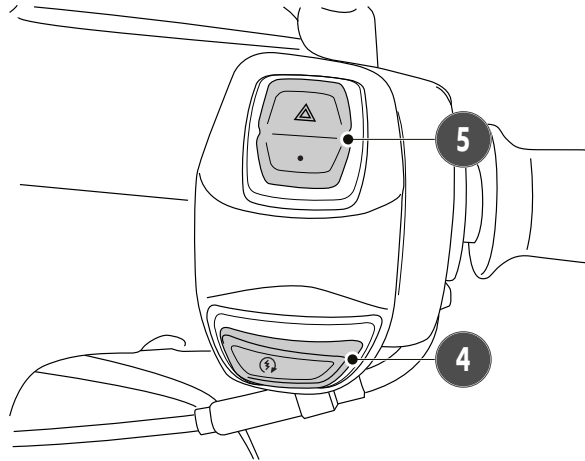

4. Starter switch.
5. Hazard warning light switch.

The hazard warning lights can only be switched on with the ignition in the ON position.

The hazard warning lights are automatically deactivated 1 hour after the ignition is switched off to save the battery.

KEY-OPERATED IGNITION SWITCH FUNCTIONS

A. Engine off position.
The engine is off. Power to the electrical circuit is off. The key can be removed.

B. On position.
Power to the electrical circuit is on. The engine can be started. The key cannot be removed.

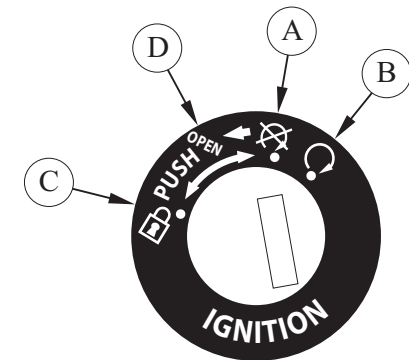

C. Steering unlocked.
Power to the electrical circuit is off. The handlebars must be turned to the left, while the key must be simultaneously pushed in and turned to the left. The key can be removed.

D. Opening the saddle.
Action of the key in this position allows you to open the saddle with a cable device.

GB

EQUIPMENTS

STORAGE COMPARTMENT / ACCESSORY SOCKET

GB

To open the flap of the glove compartment, insert the key into the lock and turn it to the right.

1 - Storage compartment

Do not leave objects in the glove compartment, whatever their value may be (key-ring, etc.). The manufacturer may not be held liable in case of theft.

2

Accessory socket 12V ¹

The accessory socket is powered when the ignition is switched on.

It can be used to connect low-voltage devices (mobile phone, GPS, etc.).

Track USB ¹

An accessory socket (max. 2.5W), which is powered when the ignition is turned on, is located in the storage compartment under the saddle .

It can be used to connect low-voltage devices (mobile phone, GPS, etc.).

The equipment can recharge automatically during use.

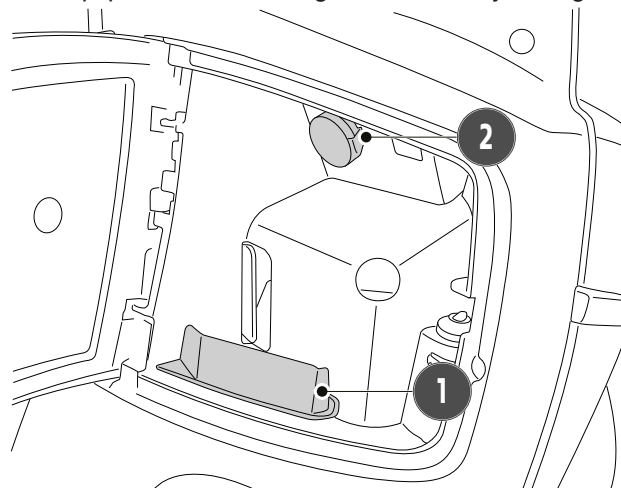

UTILITY HANGER

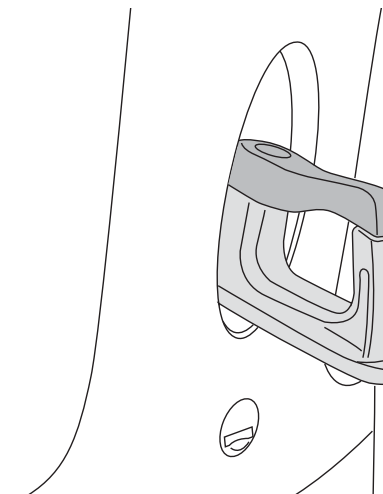

The utility hanger is located on the rear shield panel. It can be used to attach a maximum load of 2.5 kg.

LATERAL STAND

DJANGO 50 cc

The lateral kickstand is fitted with an ignition cut-out which prevents the engine from being started while the stand is down.

This system reminds the driver to lift the stand before starting the engine.

If the engine starts with the kickstand down, it is essential to have the circuit checked by an approved dealer.

DJANGO 125 cc

The stand is fitted with a contactor which will allow the engine to be started up if the stand is down but only with limited engine speed.

1. Depending on model

ACCESSORY

FRONT LUGGAGE CARRIER

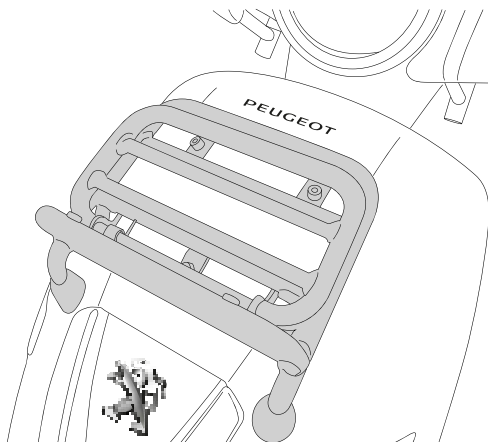

The front luggage carrier can bear a maximum load of 3 kg.

REAR LUGGAGE CARRIER



The rear luggage carrier can bear a maximum load of 6 kg.



To not place luggage on it that is too bulky and may impair the lighting and steering.

Do not exceed the maximum recommended load for each luggage carrier.

Attach luggage firmly to the vehicle, even over a short distance.

TOP CASE



The top box is delivered with 2 keys.



The maximum permissible load for the top box is 3 kg.

Opening the top box:

- Insert the key into the lock.
- Turn the key to the right in the lock and push the button (A).

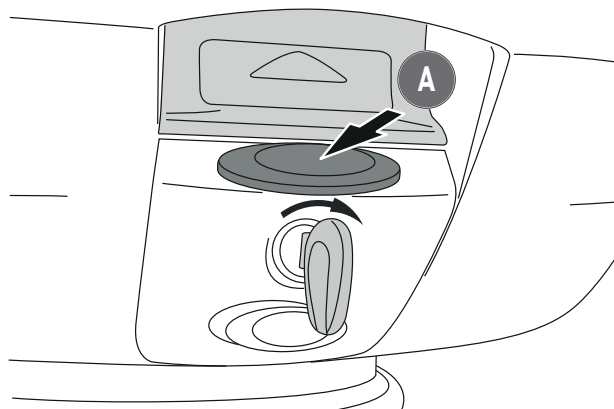

Open the top box.

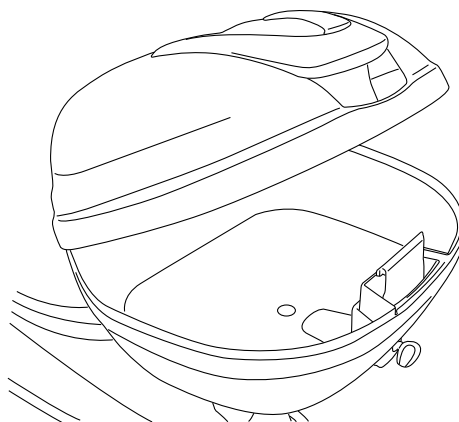

Closing the top box:

- Press on the locking flap (B) and turn the key to the left in the lock.
- Remove the key.

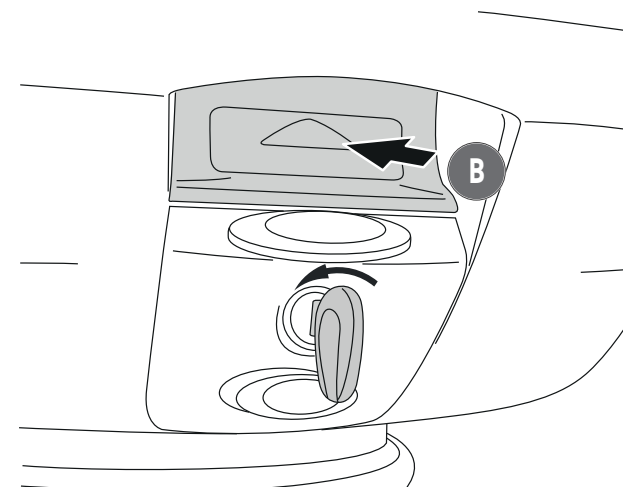

Removing the top box:

- Insert the key into the lock towards the right.
- Turn the key in the lock and push the button (C)
- Remove the top box and remove the key from the lock to avoid breaking it.

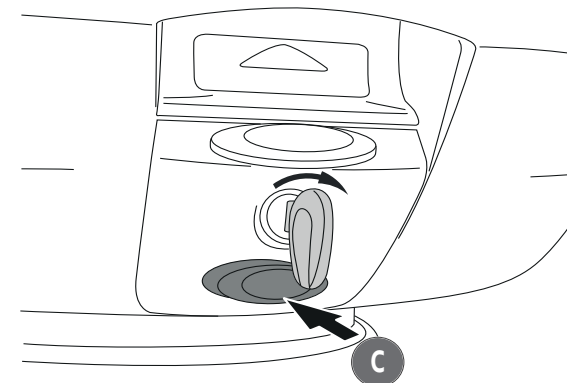

GB

Fitting the top box:



The key is not required when fitting the top box to the vehicle.

GB

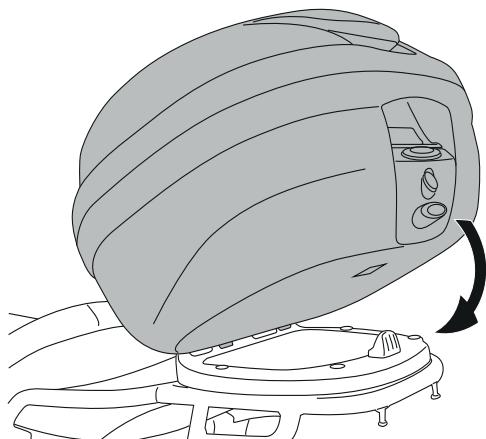

- Fit the top box into its support at the front.
- Fit the top box at the back by pressing on it and ensure it is correctly locked in place.

CHECKS TO PERFORM BEFORE USE

The user must personally ensure that his vehicle is in good condition. Certain safety elements may show signs of damage even when the vehicle is not used. e.g. prolonged exposure to bad weather can lead to oxidation in the braking system or a pressure drop in the tyres which can have serious consequences. In addition to a simple visual inspection, it is extremely important to check the following points before use.



These checks only take a few minutes and help to keep your vehicle in good condition, for optimum use combining reliability and safety.

If one of the elements in the checklist does not work properly, ask your registered dealer to check it and have it repaired if necessary before using the vehicle.

ADVICE FOR STARTING UP AND DRIVING

WARNING

Before using the vehicle for the first time, make sure you are familiar with all the controls and their respective uses. If you are not sure about the functions of any of the controls, your registered dealer can answer your questions and give you any help you may require.



As exhaust fumes are toxic, the engine must be started in a well-ventilated area. It must never be allowed to run in a closed space, even for a short time

ECO MODE

Adopt smooth driving behaviour

- Turn the acceleration handle gradually, not suddenly.
- Anticipate braking using the engine brake.
- Limit the vehicle load as well as aerodynamic resistance.
- Regularly check the inflation pressure in your tyres, and refer to the label under the seat.
- Avoid heating up the engine while stationary: the engine heats quicker when you drive.
- Have your vehicle serviced according to the manufacturer's maintenance plan.

These attitudes contribute to economising fuel consumption, reducing CO2 emissions and alleviating the background sound of traffic.

DRIVING ON FLOODED ROADS



You are strongly advised not to drive on flooded roads as this may seriously damage the engine, transmission and electrical systems on your vehicle.

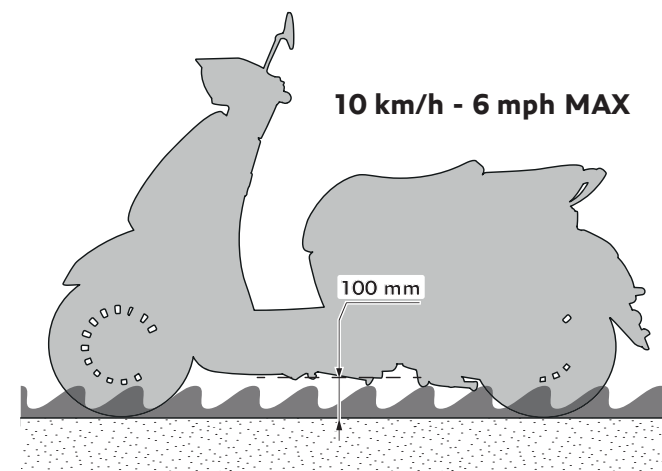

If you cannot avoid driving through flood water:

- Check that the water depth does not exceed 100, taking into account waves which could be generated by other road users.
- Under no circumstances exceed a speed of 10 km/h.
- Once out of the flooded area, brake gently several times to dry out the brakes as soon as the safety conditions allow it.

GB

INSPECTION BEFORE SETTING OFF

Component	Checks
Fuel	<ul style="list-style-type: none">• Check the fuel level in the tank.• Top up with fuel if necessary.• Check that there is no fuel leak.
Engine oil	<ul style="list-style-type: none">• Check the level of the engine oil.• If necessary, top up with the recommended oil.
Disk brakes	<ul style="list-style-type: none">• Check brake operation.• Have an approved dealer check them if they feel soft.• Check brake pad wear.• Check the level of brake fluid in the reservoir.
Drum brakes ^a	<ul style="list-style-type: none">• Check brake operation.• If necessary adjust the control.• Check the wear on the brake linings.• Correct if necessary.
Lighting, signalling, indicators, horn	<ul style="list-style-type: none">• Check operation.• Correct if necessary.

a. Depending on model.

Wheels and tyres	<ul style="list-style-type: none">• Check the tyre wear and condition.• Check the tyre pressures cold.• Correct if necessary.
Throttle	<ul style="list-style-type: none">• Check the throttle handle turns smoothly and returns correctly to its starting position.
Steering	<ul style="list-style-type: none">• Check the free rotation of the steering.
Stand	<ul style="list-style-type: none">• Check that the central and side stands can be unfolded smoothly ^a.• Operation of the ignition cut-out ^a.

STARTING THE ENGINE

For greater safety, place the vehicle on its central stand before starting the engine.

- Turn the ignition key to "ON".
- Ensure that the throttle is in the OFF position.
- Press one of the brake levers while pressing the starter button. Do not press the starter for more than 10 seconds.
- Release the starter button as soon as the engine starts.



If the engine does not start, release the starter button and the brake lever, wait a few seconds and try again.

DRIVING

Starting off

The vehicle is on its stand with the engine running.

- Squeeze the brake lever with your left hand, grip the grab handle with your right hand and push the vehicle forwards to fold up the central stand.
- Sit on the vehicle.
- Release the left brake and turn the throttle slowly with your right hand to start moving.

Accelerating and decelerating

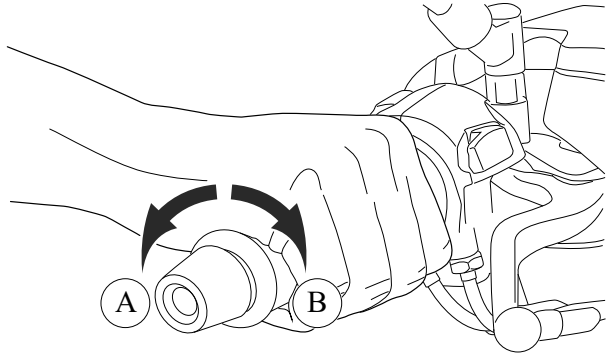

To accelerate, turn the throttle towards (A). To slow down, turn the throttle towards (B).

BRAKING

DJANGO 50 cc

Conventional braking

The right lever controls the front brake and the left lever controls the rear brake.

Use of the brakes

For good braking, it is very important to coordinate the following actions:

- Close the throttle.
- Operate the left and right brake levers simultaneously and slowly increase the pressure.



Using only one brake reduces braking efficiency and can lock the wheel, causing a fall.

Avoid braking suddenly on wet roads or in bends.

Reduce speed on steep slopes to avoid prolonged braking, as overheating will reduce braking efficiency.

DJANGO 125 cc

Braking system ABS

This is a wheel anti-lock system.

- Controlled by the right lever, it acts on the front wheel.
- The ABS system enables the rider to retain control of the vehicle when braking in slippery conditions.
- The left brake lever operates like a standard braking system by acting on the rear wheel.

Use of the brakes

- Close the throttle.
- Activate the brake system by gradually increasing the pressure.



Avoid braking suddenly on wet roads or in bends.

Reduce speed on steep slopes to avoid prolonged braking, as overheating will reduce braking efficiency.

FUEL SUPPLY



The engine must be switched off in order to fill the fuel tank in complete safety.

A label affixed near the fuel cap reminds you of the type of fuel to use.

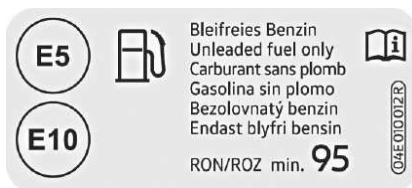

- Place the vehicle on the central stand.
- To open the fuel hatch, insert the key into the lock and turn to the left.
- When filling up with fuel, ensure the end of the nozzle is correctly inserted into the filling orifice on the fuel tank.

While filling, place the cap in the holder provided for this purpose on the inside of the flap.

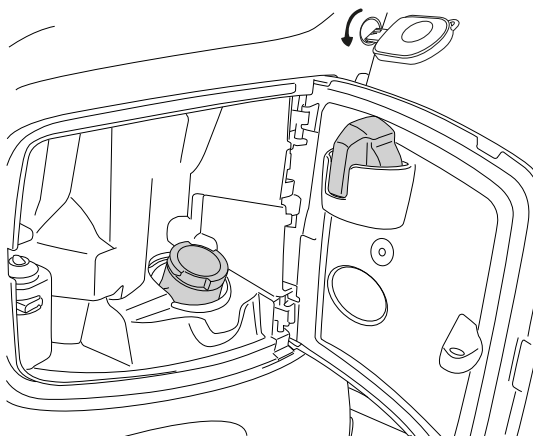

Any overflows must be wiped up immediately.

The fuel could actually damage painted surfaces or plastic parts.

Do not fill the fuel tank to excess: The fuel may expand due to the engine heat or heat from the sun and overflow

RUNNING IN THE ENGINE

Running in the engine is essential to guarantee its performance and lifetime.

During the running-in period, you are advised not to overload the engine and to avoid exceeding a higher than normal operating temperature.

From 0 to 500 km.

Do not hold the throttle handle open at more than half its distance of travel over a long trip.

From 500 to 1000 km.

Do not hold the throttle handle open at more than 3/4 its distance of travel over a long trip.

Once this mileage has been done, the vehicle can be used normally.

SWITCHING OFF THE ENGINE AND PARKING

The engine is switched off when at idling speed by turning the ignition key to "OFF".

The vehicle should be preferably parked on flat ground.

- Either on the middle stand.
- Or on the lateral stand.

Each time the vehicle is parked, the steering should be locked and the ignition key removed.

SERVICE OPERATIONS

MAINTENANCE ADVICE

Ensure that the servicing schedule for your vehicle is strictly followed to maintain your contractual warranty rights.

A table of inspections for the maintenance schedule is inserted into the maintenance booklet. The registered dealer must add his stamp, the date of servicing and the number of kilometres the vehicle has covered.

In order to maintain maximum safety and reliability of your vehicle, you are advised to have maintenance and repairs carried out by a registered dealer who has the necessary technical training, specific tools and spare parts.

ENVIRONMENT / RECYCLABLE

Worn parts replaced during routine maintenance (mechanical parts, battery, etc.) must be disposed of with specialised bodies.

At the end of its life, the vehicle must be taken to an authorised centre for recycling.

In all cases, comply with the local laws.



Batteries contain harmful substances. They must be disposed of according to the legal requirements and must under no circumstances be thrown away in the household waste.

CLEANING THE VEHICLE



The bodywork is made of plastic parts that can be painted or are shiny. Do not use solvents or cleaning products that are too corrosive.

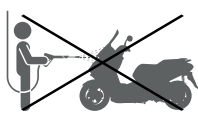

Do not use high pressure cleaners which may cause water to infiltrate the following parts: seals, bearings and hinges, electrical components such as connectors, contactors and lighting.

Wash the bodywork with soapy water and rinse with generous amounts of clear water.

The vehicle can be dried with a chamois leather. After washing the vehicle, brake several times at low speed to dry out the brakes.



The vehicle should be washed in a place equipped for wastewater collection

Certain silicon-based products can alter the quality of the paintwork. In case of need or doubt, a registered dealer can advise you on using cleaning products or restoring scratched bodywork.

SPARK PLUG INSPECTION OR REPLACEMENT



It is essential to use a resistive spark suppressor and a resistive spark plug in accordance with the manufacturer's recommendations.

The engine must be cold.

- Remove the saddle storage compartment.
- Remove the fairing under the saddle.
- Disconnect the suppressor.
- Remove the spark plug.
- Measure the distance between the electrodes and correct it if necessary (A).

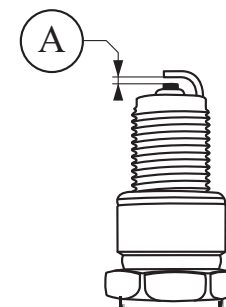

A. Electrode gap: 0.6 to 0.7 mm.

Recommended spark plug

NGK CR7HSA

- Fit and screw in the spark plug manually.
- Tighten the spark plug with a spanner.
 - 1/8 - 1/4 turn for a reused spark plug.
 - 1/2 turn for a new spark plug.



Ensure the suppressor is correctly clipped onto the spark plug.

Have the torque quickly checked by a registered dealer.

GB

ENGINE OIL LEVEL

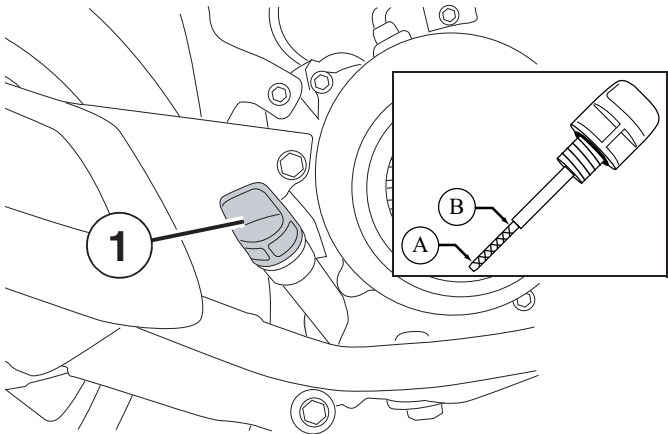

- Place the vehicle on its central stand on flat ground.
- Start the engine, let it run for a few minutes and then stop it.
- Wait a few minutes for the oil to stabilise.
- Remove the cap/oil gauge (1).
- Wipe the cap/gauge and reinsert it into the filling orifice without screwing it up.
- Remove the filler cap/gauge and check the oil level
- The oil level shall not be between the minimum (A) and maximum (B) level marks without exceeding the latter.
- Add oil if necessary.



Too much oil will noticeably restrict the vehicle's performance.

CHANGING THE ENGINE OIL



We advise you to go to a registered dealer for draining.



Oil contains substances which are harmful to the environment. Your dealer is equipped to dispose of used oil without endangering the environment and in compliance with current standards

Engine oil
50 cc
SAE 5W40 Synthetic API SL/SJ
Quantity: 0.65 l at oil change
125 cc
SAE 5W40 Synthetic API SL/SJ or SAE 15W50 Synthetic API SL/SJ
Quantity: 0.75 l at oil change

When the ambient temperature is below 0 °C, use an oil of viscosity: 5W40.

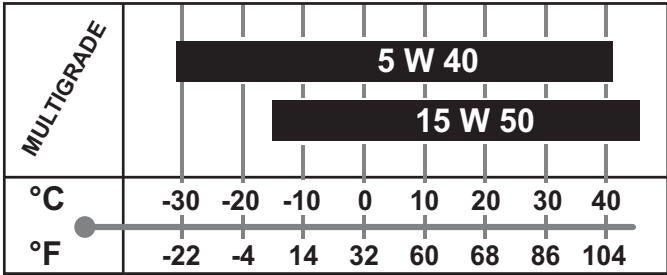

The engine must be drained when it is warm to allow the oil to run easier.

- Place the vehicle on its central stand on flat ground.
- Put on protective gloves.
- Remove the cap/oil gauge.
- Remove the drainage cap and its seal (2) and allow the oil to drip into a recipient.

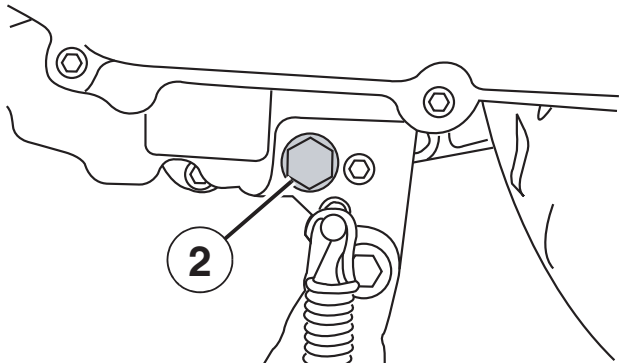

- Remove the strainer cap (3) and clean the strainer.

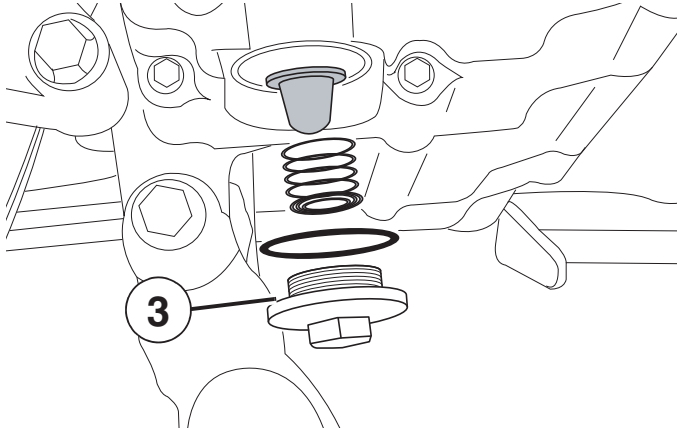

- Put back the drainage cap and strainer cap, fitted with a new seal.
- Pour the required quantity of oil corresponding to the manufacturer's standards into the filler hole.
- Start the engine and let it run for a short while.
- Remove the filler cap/gauge and check the oil level.
- Add oil if necessary.
- Check that the oil drain plug is sealed.

DRAINING THE RELAY BOX



We advise you to go to a registered dealer for draining.



Oil contains substances which are harmful to the environment. Your dealer is equipped to dispose of used oil without endangering the environment and in compliance with current standards

The gearbox must be drained when the engine is warm so that the oil will run easier.

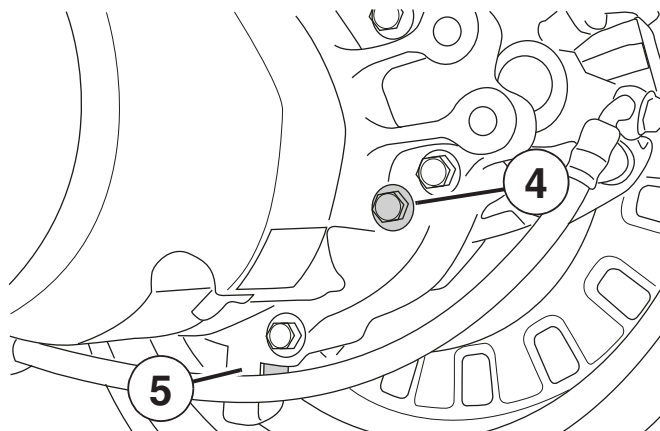

- Place the vehicle on its central stand on flat ground.
- Place a container under the drain port.
- Remove the relay box filler cap (4).
- Remove the drain plug (5).
- Re-install the plug with a new seal.
- Pour the required quantity of oil corresponding to the manufacturer's standards into the filler hole.

Fit the filler cap.

Relay box	
SAE 80W90 API GL4	
Quantity	
50 cc	0.12 l at oil change
125 cc	0.18 l at oil change

- Insert the drain plug fitted with a new seal.
- Pour the required quantity of oil corresponding to the manufacturer's standards into the filler hole.
- Fit the cap/oil gauge.
- Start the engine and let it run for a short while.
- Check and adjust the oil level if necessary.
- Check that the oil drain plug is sealed.

REPLACING THE AIR FILTER



You are advised to contact a registered dealer to have this operation carried out.

THROTTLE CABLE PLAY

The play in the throttle control must be 3 to 5 mm on the handle (A).

If the play is incorrect, use the setting nut to adjust it (2).

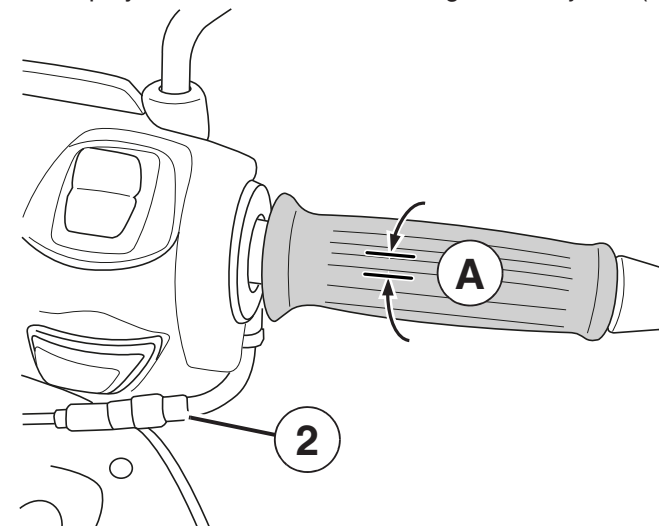

GB

TYRES

Tyre pressure should be cold-checked regularly. Incorrect pressure causes abnormal wear and affects road behaviour, thus making driving dangerous.

	Tyre pressures	
	Front	Rear
Solo	1.8 bars	2 bars
Pillion	1.8 bars	2.2 bars

If the wear limit on the tread is reached (T), you are advised to go to a registered dealer to change the tyres.

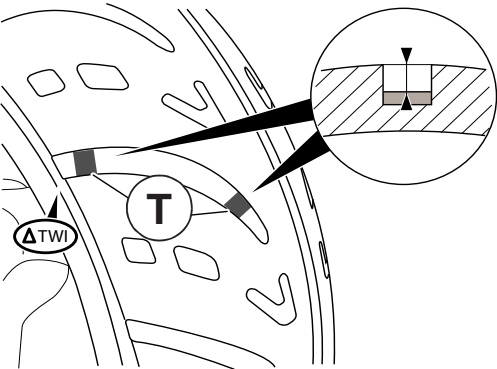

When replacing tyres, you are advised to mount tyres of the same brand and equivalent quality. In case of puncture, it is forbidden to mount an inner tube in a tubeless tyre.



Tyres contain substances that are harmful to the environment. Your dealer is equipped to dispose of used tyres without endangering the environment in compliance with current standards.

BRAKE INSPECTION



We advise you to visit a registered dealer for the replacement of these components.

Front brake pad wear

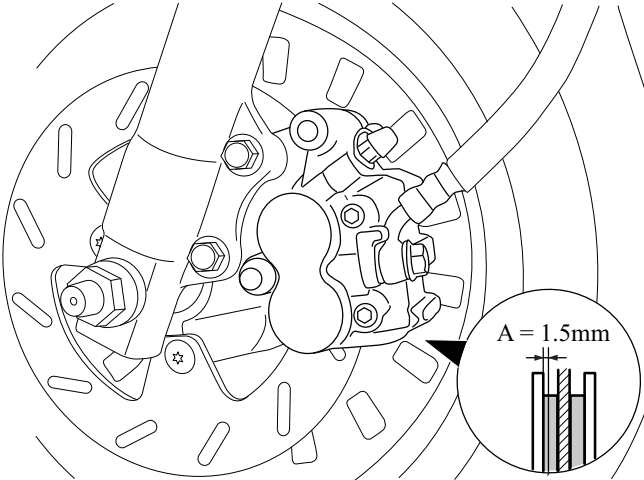

Rear brake pad wear ¹

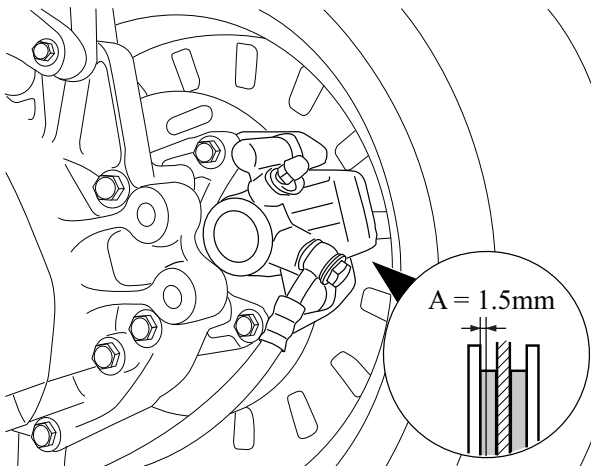

If one of the 2 brake pads is worn down to the minimum dimensions (A), the 2 brake pads must be changed.

Rear brake lining wear ²

When it is no longer possible to adjust the control tension nut, the brake pads are worn.

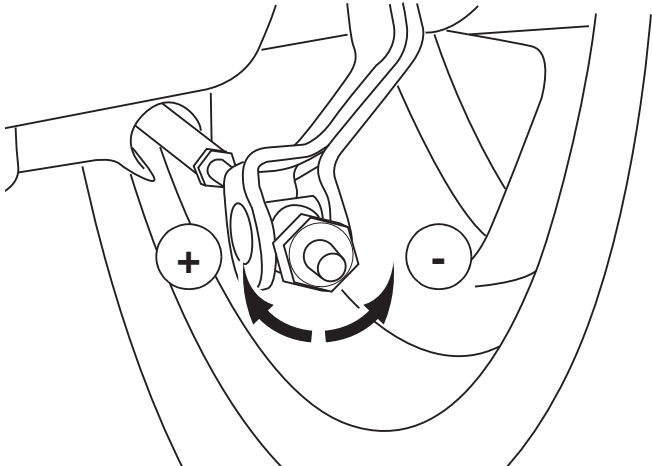

Actuate the brake control lever and check the position of the wear mark on the cam tierod (B) compared to the mark (C) on the engine housing.

If the cam tierod mark is aligned or with the wear mark or exceeds it, the brake linings must be changed.

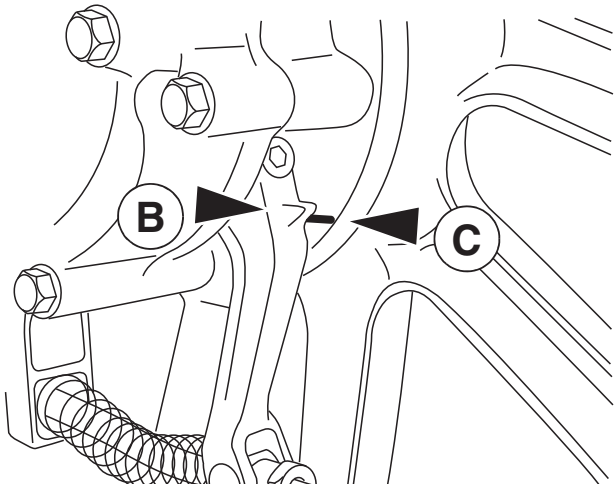

1. Depending on model.

2. Depending on model.



The brake fluid levels must be checked regularly through the braking unit inspection window (B).

If the level is close to the minimum mark, we advise you to go to a registered dealer to have the braking system checked and topped up if necessary.

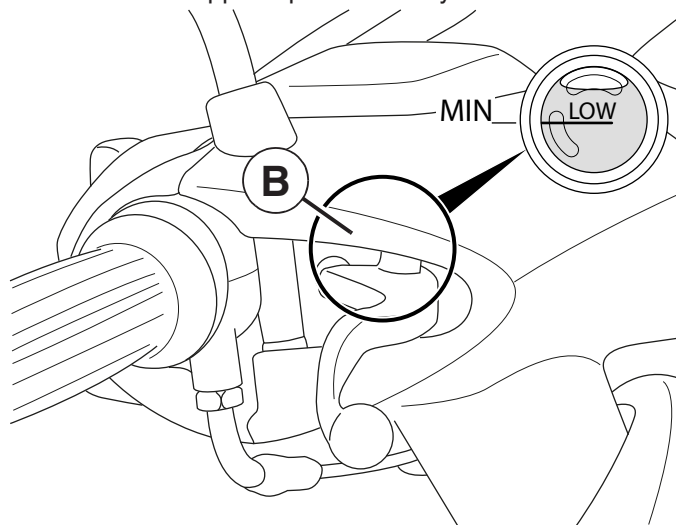

BATTERY



Make sure you check that the battery is disconnected before performing any operations on it.

Battery power leads must never be disconnected while the engine is running.

To avoid damage to the electronic circuit, do not charge the battery if it is connected to the vehicle.



The sulphuric acid contained in the battery electrolyte can cause serious burns.

Avoid all contact with the skin, eyes or clothing and always protect your eyes when working near the battery.

In case of leakage, you are advised to consult a registered dealer who is equipped to replace and dispose of batteries without endangering nature and the environment.



A battery produces explosive gases.

Keep the battery away from sparks, flames, cigarettes, etc...

It should be charged in a well-ventilated area.

Extended periods of immobilisation and storage



If the vehicle is not used for an extended period, the battery will slowly discharge naturally or due to its electronics or certain accessories and must thus be regularly charged.

If the vehicle is not used for a period of 1 month or longer, the battery charge must be preserved:

- Using a maintenance charger (if the vehicle is not used for a long period).
- If not, by disconnecting it from the vehicle (if the vehicle is not used for a period of less than 2 months).



If these recommendations are not followed, the battery may go into deep discharge. In this case the manufacturer's warranty will be void.

Removal of the battery

To access the battery, remove the passenger saddle and the battery cover.

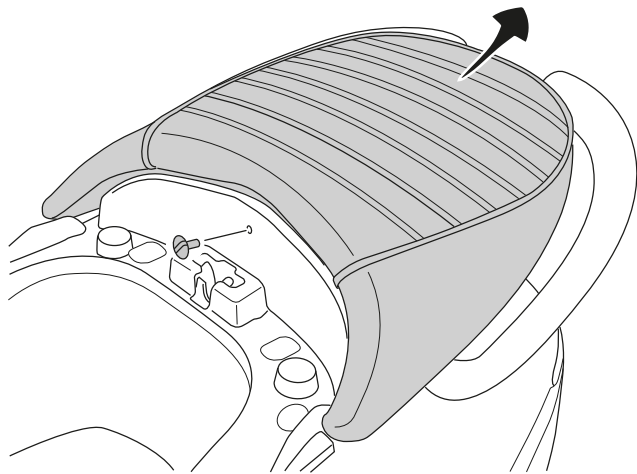

Disconnect the battery in the following order:

- 1. The negative terminal.
- 2. The positive terminal.

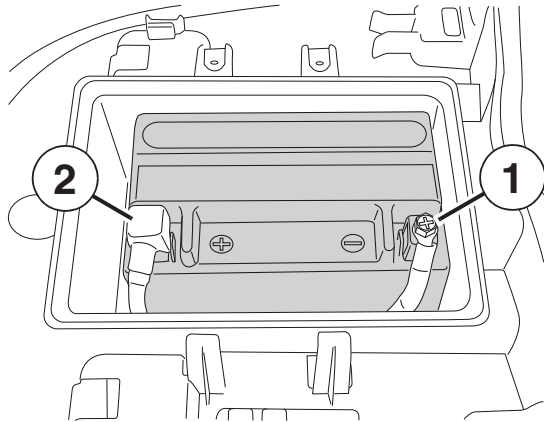

Battery charge

The battery must be charged in a well-ventilated area with a suitable charger that can feed a tenth of the battery capacity to avoid premature destruction. You are therefore advised to go to a registered dealer to carry out this operation.

Batteries contain sulphuric acid. Do not allow it to come into contact with skin or eyes. While the battery is charging, it can release explosive gases. Keep sources of sparks, flames and incandescent products away from it.

Maintenance-free batteries

 **A maintenance-free battery must never be opened for topping up.**

- Disconnect and remove the battery.
- Charge the battery to 100% beforehand.
- Use a maintenance charger or charge monthly.
- Before restarting, the battery must be charged to 100%.

Installing the battery

Connect the batter in the following order:

- 1. The positive terminal.
- 2. The negative terminal.

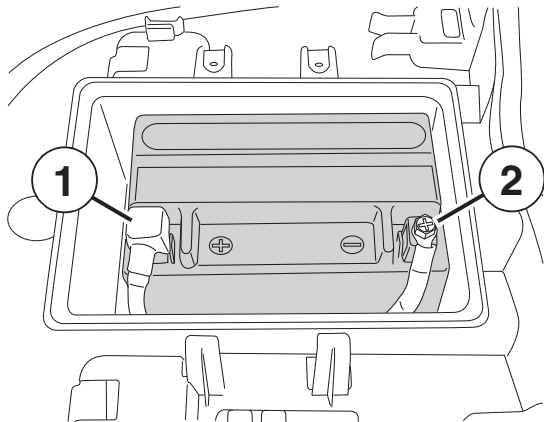

FUSES

- To access the fuses, remove the passenger saddle.

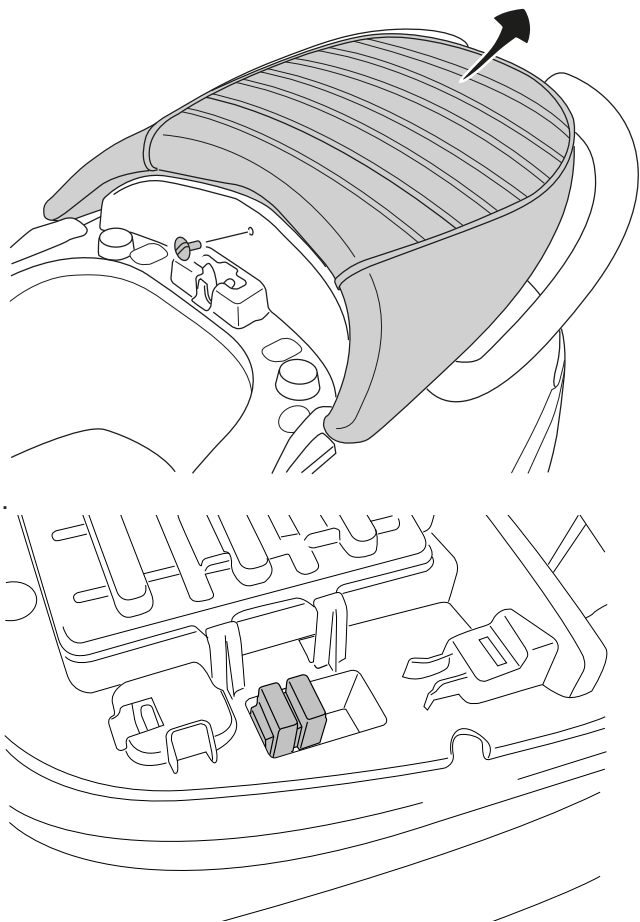



If a fuse often blows this is usually a sign of a short circuit in the electrical circuit. You are advised to have the system checked by a registered dealer.

You are advised to switch off the ignition before changing a fuse and always to replace it with a fuse of the same rating. If you do not do so, this may lead to damage in the electrical circuit or even a fire.

- Find the faulty fuse by looking at the condition of its filament.

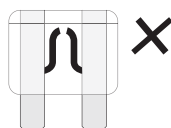
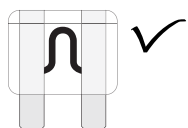

Before changing a fuse, you must find the reason for the fault and correct it.

Always replace the faulty fuse with a fuse of the same rating.

	Fuse allocation	
	50 cc	125 cc
20A		Main fuse
15A	Main fuse	
10A	Electrical equipment	
10A	Injection system	ABS System
5A		Accessory socket

BULB REPLACEMENT



You are advised to contact a registered dealer to have this operation carried out.

Headlight bulb

- Remove the front shield panel (1).
- Remove the windshield (2) ¹.
- Remove the headlight fairing (3).

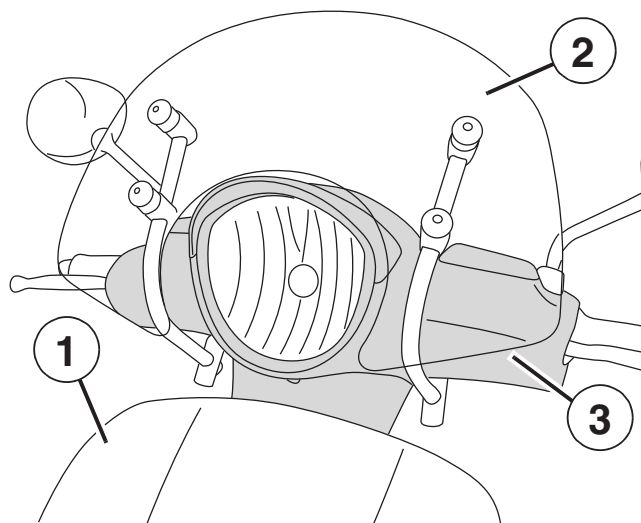

Headlight bulb	
50 cc	12V - 35/35W (HS1)
125 cc	12V - 60/55W (H4)

1. Depending on equipment

Number plate light bulb

- Remove the lamp lens (4).

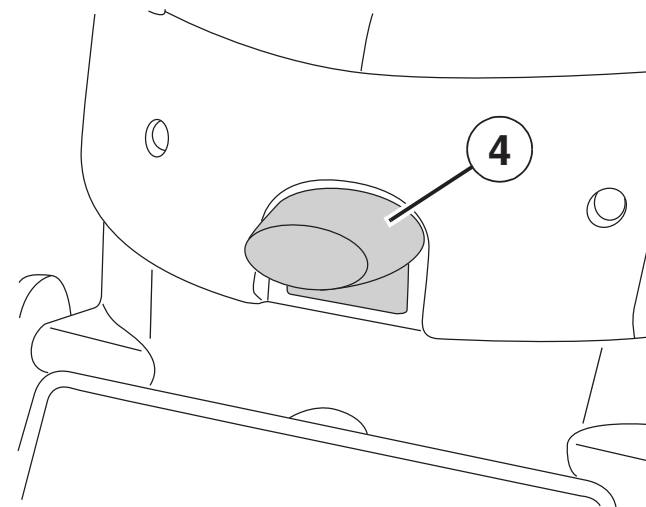

GB

HEADLIGHT ADJUSTMENT

The headlights are adjusted with one set-screw per lamp, which can be accessed from the rear shield panel.

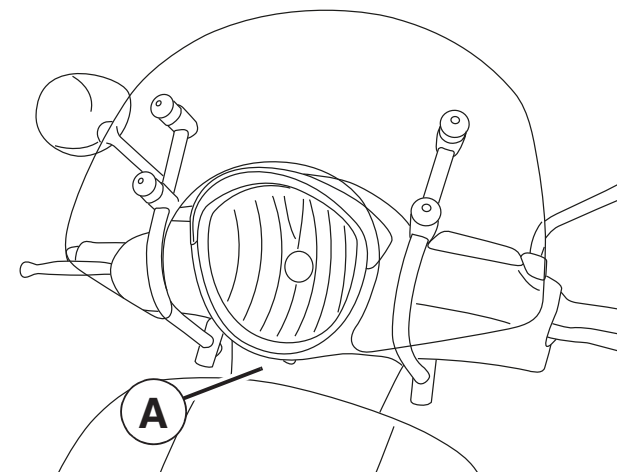

- Loosen the attachment screw (A).
- Adjust the direction of the headlamp by hand.
- Tighten the fastening screw.



**ISO 9001 (Édition 2008) /
N°SQ/1956**

**Peugeot Motocycles SA
Rue du 17 Novembre
F-25350 Mandeure**

Tél. +33(0)3 81 36 80 00

Fax +33(0)3 81 36 80 80

RCS Belfort B 875 550 667

**www.peugeot-motocycles.fr
www.peugeot-motocycles.com**

0 800 007 216

**Service & appel
gratuits**

Dans un souci constant d'amélioration Peugeot Motocycles se réserve le droit de supprimer, modifier, ou ajouter toutes références citées.
DQ/APV du 7/2020 (photos non contractuelles).



PEUGEOT
MOTOCYCLES



Guide d'utilisation en ligne
Online user's guide

i-Connect® : application Peugeot Motocycles disponible sur
i-Connect® : Peugeot Motocycles app available on

